

# Installation Fittings

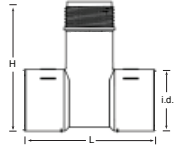

## PVC-U Tees SCH 80 - Fitting Only (Available in USA/ASIA)

Part No.	Code No.	Size [in.]	Sensor Type - Flow, pH/ORP	L [in.]	H [in.]	i.d. [in.]
MPV8T005F	159 001 614	0.50	Flow -X0, pH -XX	3.75	3.50	0.85
MPV8T007F	159 001 615	0.75	Flow -X0, pH -XX	3.75	3.70	1.06
MPV8T010F	159 001 616	1.00	Flow -X0, pH -XX	4.30	4.00	1.33
MPV8T012F	159 001 617	1.25	Flow -X0, pH -XX	4.40	4.30	1.67
MPV8T015F	159 001 618	1.50	Flow -X0, pH -XX	5.00	4.60	1.91
MPV8T020F	159 001 619	2.00	Flow -X0, pH -XX	5.50	5.00	2.40

- For use with Flow: P51530-X0, 3-2536-X0, 3-8510-X0, 3-8512-X0, 3-2537-XC-X0, 3-2551-X0-X0-XX

- For use with pH/ORP: 3-272X-XX, 3-273X-XX
- NSF

## PVC-U Tees SCH 80 - with Pipe<sup>1</sup> (Available in USA/ASIA)



Part No.	Code No.	Size [in.]	Sensor Type - Flow, pH/ORP	L [in.]	H [in.]	o.d. [in.]
MPV8T005	159 001 623	0.50	Flow -X0, pH -XX	14	3.50	0.84
MPV8T007	159 001 624	0.75	Flow -X0, pH -XX	14	3.70	1.05
MPV8T010	159 001 625	1.00	Flow -X0, pH -XX	17	4.00	1.32
MPV8T012	159 001 626	1.25	Flow -X0, pH -XX	20	4.30	1.66
MPV8T015	159 001 627	1.50	Flow -X0, pH -XX	24	4.60	1.90
MPV8T020	159 001 628	2.00	Flow -X0, pH -XX	26.5	5.02	2.38

- For use with Flow: P51530-X0, 3-2536-X0, 3-8510-X0, 3-8512-X0, 3-2537-XC-X0, 3-2551-X0-X0-XX

- For use with pH/ORP: 3-272X-XX, 3-273X-XX

<sup>1</sup>Pipe lengths included with these fittings do not satisfy straight-run requirements for all installation configurations

## PVC-U Tees SCH 80 - with Pipe<sup>1</sup> (Available in USA/ASIA)



Part No.	Code No.	Size [in.]	Sensor Type - Flow, pH/ORP	L [in.]	H [in.]	o.d. [in.]
PV8T025	198 801 573	2.50	Flow -X0, pH -XX	24	5.4	2.88
PV8T030	198 801 416	3.00	Flow -X0, pH -XX	24	6.0	3.50
PV8T040	198 801 436	4.00	Flow -X0, pH -XX	24	7.0	4.50

- For use with Flow: P51530-X0, 3-2536-X0, 3-8510-X0, 3-8512-X0, 3-2537-XC-X0, 3-2551-X0-X0-XX

<sup>1</sup>Pipe lengths included with these fittings do not satisfy straight-run requirements for all installation configurations

- For use with pH/ORP: 3-272X-XX, 3-273X-XX

## PVC-U Clamp-on Saddles SCH 80 (Available in USA/ASIA)

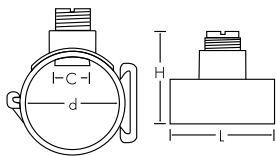

Part No.	Code No.	Size [in.]	Sensor Type - Flow, pH/ORP	L [in.]	H [in.]	d [in.]	C [in.]
PV8S020	159 000 637	2.00	Flow -X0, pH -XX	4.00	5.0	2.375	1.43
PV8S025	159 000 638	2.50	Flow -X0, pH -XX	4.75	5.4	2.875	1.43
PV8S030	198 150 577	3.00	Flow -X0, pH -XX	5.00	6.0	3.500	1.43
PV8S040	198 150 578	4.00	Flow -X0	5.00	7.1	4.500	1.43
PV8S060	198 150 579	6.00	Flow -X1	5.00	10.0	6.625	2.25
PV8S080	159 000 639	8.00	Flow -X1	5.00	11.5	8.625	2.25

- For use with Flow: P51530-X0/-X1, 3-2536-X0/-X1, 3-8510-X0/-X1, 3-8512-X0/-X1, 3-2537-XC-X0/-X1, 3-2551-X0-XX/-X1-XX

- Mounts on PVC pipe
- C - Clearance dimension
- EPR (EPDM) O-ring
- NSF

- For use with pH/ORP: 3-272X-XX, 3-273X-XX

## PVC-C Tees SCH 80 - Fitting Only (Available in USA/ASIA)

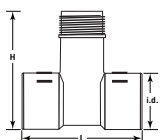

Part No.	Code No.	Size [in.]	Sensor Type - Flow, pH/ORP	L [in.]	H [in.]	i.d. [in.]
MCPV8T005F	159 001 632	0.50	Flow -X0, pH -XX	3.75	3.50	0.85
MCPV8T007F	159 001 633	0.75	Flow -X0, pH -XX	3.75	3.70	1.06
MCPV8T010F	159 001 634	1.00	Flow -X0, pH -XX	4.30	4.00	1.33
MCPV8T012F	159 001 635	1.25	Flow -X0, pH -XX	4.40	4.30	1.67
MCPV8T015F	159 001 636	1.50	Flow -X0, pH -XX	5.00	4.60	1.91
MCPV8T020F	159 001 637	2.00	Flow -X0, pH -XX	5.50	5.00	2.40

- For use with Flow: P51530-X0, 3-2536-X0, 3-8510-X0, 3-8512-X0, 3-2537-XC-X0, 3-2551-X0-X0-XX

- For use with pH/ORP: 3-272X-XX, 3-273X-XX

# Installation Fittings

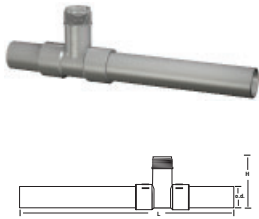

## PVC-C Tees SCH 80 - with Pipe<sup>1</sup> (Available in USA/ASIA)

Part No.	Code No.	Size [in.]	Sensor Type - Flow, pH/ORP	L [in.]	H [in.]	o.d. [in.]
MCPV8T005	159 001 641	0.50	Flow -X0, pH -XX	14	3.50	0.84
MCPV8T007	159 001 642	0.75	Flow -X0, pH -XX	14	3.70	1.05
MCPV8T010	159 001 643	1.00	Flow -X0, pH -XX	17	4.00	1.32
MCPV8T012	159 001 644	1.25	Flow -X0, pH -XX	20	4.30	1.66
MCPV8T015	159 001 645	1.50	Flow -X0, pH -XX	24	4.60	1.90
MCPV8T020	159 001 646	2.00	Flow -X0, pH -XX	26.5	5.02	2.38

- For use with Flow: P51530-X0, 3-2536-X0, 3-8510-X0, 3-8512-X0, 3-2537-XC-X0, 3-2551-X0-X0-XX
- For use with pH/ORP: 3-272X-XX, 3-273X-XX

<sup>1</sup>Pipe lengths included with these fittings do not satisfy straight-run requirements for all installation configurations

Multi-Parameter Instruments

Communication Protocol

Chlorine

Dissolved Oxygen

Flow

pH/ORP

Conductivity/Resistivity

Level

Temperature

Pressure

Other Products

Installation & Wiring

Technical Reference

Temperature/Pressure Graphs

## PP-H, Wafer Fitting, Metric and Inch (EPR/EPDM gaskets) (Available in USA/ASIA/EUROPE)

Part No.	EPDM Code No.	d [in.]	DN [mm]	Sensor Type - Flow	PN	d [mm]	D [mm]	H [mm]	L [mm]	L1 [mm]
PPMTE025	727 311 012	2.50	65	Flow -X1	10	75	88	133	48	61
PPMTE030	727 311 013	3.00	80	Flow -X1	10	90	102	140	48	69
PPMTE040	727 311 014	4.00	100	Flow -X1	10	110	132	149	48	79
PPMTE060	727 311 017	6.00	150	Flow -X1	10	160	182	156	48	106

- For use with Flow: P51530-X1/-X2, 3-2536-X1/-X2, 3-8510-X1, 3-8512-X1, 3-2537-XC-X1, 3-2551-X1-XX/X2-XX
- Threaded outlet 1 1/4 inch NPSM
- Sensor length depends on installation fitting
- Suitable for backing flanges metric and inch

- Suitable for SDR 11 - SDR 17.6
- Delivered with profile O-ring
- Wafer can be used with other pipe materials

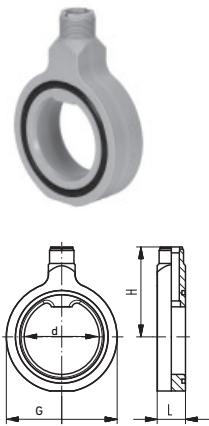

## PP-H, Wafer Fitting, Metric and Inch (FKM gaskets) (Available in USA/ASIA/EUROPE)

Part No.	FKM Code No.	d [in.]	DN [mm]	Sensor Type - Flow	PN	d [mm]	D [mm]	H [mm]	L [mm]	L1 [mm]
PPMTF040	727 311 044	4.00	100	Flow -X1	10	110	132	145	48	79

- For use with Flow: P51530-X1/-X2, 3-2536-X1/-X2, 3-8510-X1, 3-8512-X1, 3-2537-XC-X1, 3-2551-X1-XX/X2-XX
- Threaded outlet 1 1/4 inch NPSM
- Sensor length depends on installation fitting

- Suitable for backing flanges metric and inch
- Suitable for SDR 11 - SDR 17.6
- Delivered with profile O-ring
- Wafer can be used with other pipe materials

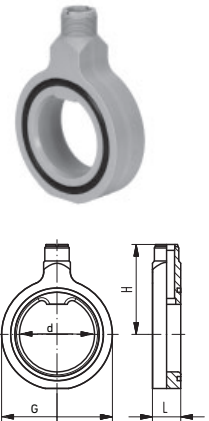

## SYGEF Standard, Metric and Inch (FKM gaskets) (Available in USA/ASIA/EUROPE)

Part No.	FKM Code No.	d [in.]	d [mm]	Sensor Type - Flow	PN	DN [mm]	H [mm]	D [mm]	L [mm]	L1 [mm]
SFMTF030	735 311 043	3.00	90	Flow -X1	10/16	80	141	102	48	69

- For use with Flow: P51530-X1, 3-2536-X1, 3-8510-X1, 3-8512-X1, 3-2537-XC-X1, 3-2551-X1-XX
- Threaded outlet 1 1/4 inch NPSM
- Sensor length depends on installation fitting

- Suitable for backing flanges metric and inch
- Delivered with profile O-ring
- Wafer can be used with other pipe materials

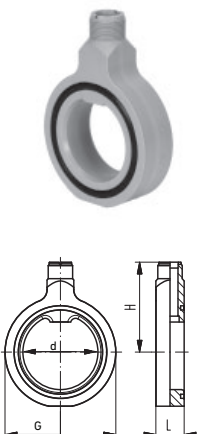

# Installation Fittings

## 310 PVC-U For socket systems Inch BS (Available in USA/ASIA/EUROPE)

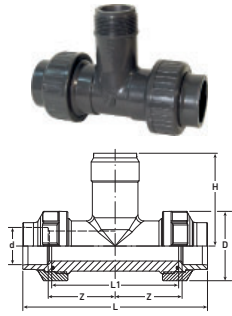

Part No.	FKM Code No.	EPDM Code No.	d [in.]	DN [mm]	Sensor Type - Flow, pH/ORP	PN	D [mm]	z [mm]	L [mm]	L1 [mm]	H [mm]
PVAT007	721 310 337	721 310 307	¾	20	Flow -X0, pH -XX	15	51	53	147	100	78
PVAT010	721 310 338	721 310 308	1	25	Flow -X0, pH -XX	15	58	58	164	110	81
PVAT012	721 310 339	721 310 309	1¼	32	Flow -X0, pH -XX	15	72	58	171	110	85
PVAT015	721 310 340	721 310 310	1½	40	Flow -X0, pH -XX	15	83	63	188	120	89
PVAT020	721 310 341	721 310 311	2	50	Flow -X0, pH -XX	15	100	68	211	130	95

- For use with Flow: P51530-X0, 3-2536-X0, 3-8510-X0, 3-8512-X0, 3-2537-XC-X0, 3-2551-X0-XX
- For use with pH/ORP: 3-272X-XX, 3-273X-XX
- BSP - British Standard Pipe
- Threaded outlet 1¼ inch NPSM
- Sensor length depends on installation fitting

## BSP PVC-U, Clamp-on Saddle, BS Inch (Available in USA/ASIA/EUROPE)



Part No.	Code No.	d [in.]	DN [mm]	Sensor Type - Flow, pH/ORP	d [mm]	PN	D [mm]	H [mm]	H1 [mm]	L [mm]
PVAS030	198 150 550	3	80	Flow -X0, pH -XX	90	15	39	105	225	105
PVAS040	198 150 551	4	100	Flow -X0, pH -XX	110	15	39	114	264	105
PVAS060	198 150 554	6	150	Flow -X1	160	15	39	156	339	120

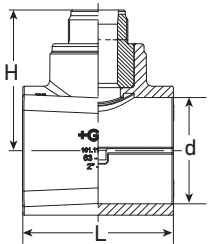

- For use with Flow: P51530-X0/-X1, 3-2536-X0/-X1, 3-8510-X0/-X1, 3-8512-X0/-X1, 3-2537-XC-X0/-X1, 3-2551-X0-XX/-X1-XX
- For use with pH/ORP: 3-272X-XX, 3-273X-XX
- Sensor length depends on installation fitting
- BSP - British Standard Pipe
- Threaded outlet 1¼ inch NPSM
- Sensor length depends on installation fitting
- EPR (EPDM) Gasket

Alternative solution can be a PP saddle or wafer. Pipe size, pressure rating and chemical resistance need to be evaluated.

## PVC-U Glue-on Saddle Fitting SCH 80 (Available in USA/ASIA)



Part No.	Code No.	Size [in.]	Sensor Type - Flow	L [in.]	H [in.]	o.d. [in.]	C [in.]
PV8S100	159 000 695	10.00	Flow -X2	9.0	5.43	10.75	2.25
PV8S120	159 000 696	12.00	Flow -X2	9.0	5.15	12.75	2.25

- For use with Flow: P51530-X2, 3-2536-X2, 3-2551-X2-XX

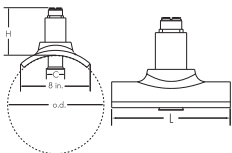

# Installation Fittings

## PVC-U Clamp-on Saddle, Metric (Available in USA/ASIA/EUROPE)

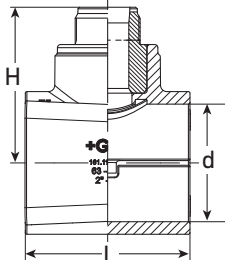

Part No.	Code No.	d [mm]	DN [mm]	Sensor Type - low, pH/ORP	PN	H [mm]	L [mm]
PVMS025	198 150 538	75	65	Flow -X0, pH -XX	16	99	105
PVMS030	198 150 539	90	80	Flow -X0, pH -XX	16	105	105
PVMS040	198 150 540	110	100	Flow -X0, pH -XX	16	114	105
PVMS060	198 150 543	160	150	Flow -X1	16	156	120
PVMS080	198 150 545	225	200	Flow -X1	16	184	120

- For use with Flow: P51530-X0/-X1, 3-2536-X0/-X1, 3-8510-X0/-X1, 3-8512-X0/-X1, 3-2537-XC-X0/-X1, 3-2551-X0-XX/-X1-XX
- For use with pH/ORP: 3-272X-XX, 3-273X-XX
- Sensor length depends on installation fitting
- Threaded outlet 1 1/4 inch NPSM
- Top saddle for solvent cement bonding
- Seal: Lip seal of EPDM
- pH sensors can only be used up to 4 in. or DN100 pipe

## PVC-U for Socket Systems, Metric (Available in USA/ASIA/EUROPE)

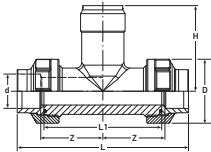

Part No.	FKM Code No.	EPDM Code No.	d [mm]	DN [mm]	Sensor Type - Flow, pH/ORP	PN	D [mm]	z [mm]	L [mm]	L1 [mm]	H [mm]
PVMT005	721 310 036	721 310 006	20	15	Flow -X0, pH -XX	16	43	48	128	90	76
PVMT007	721 310 037	721 310 007	25	20	Flow -X0, pH -XX	16	51	53	144	100	78
PVMT010	721 310 038	721 310 008	32	25	Flow -X0, pH -XX	16	58	58	160	110	81
PVMT012	721 310 039	721 310 009	40	32	Flow -X0, pH -XX	16	72	58	168	110	85
PVMT015	721 310 040	721 310 010	50	40	Flow -X0, pH -XX	16	83	63	188	120	89
PVMT020	721 310 041	721 310 011	63	50	Flow -X0, pH -XX	16	100	68	212	130	95

- For use with Flow: P51530-X0, 3-2536-X0, 3-8510-X0, 3-8512-X0, 3-2537-XC-X0, 3-2551-X0-XX
- For use with pH/ORP: 3-272X-XX, 3-273X-XX
- To install this installation fitting in PVC-C, PP-R and PE pipes; replace the original union ends with PVC-C, PP-R and PE union ends.
- Threaded outlet 1 1/4 inch NPSM
- Sensor length depends on installation fitting

## PP-H for Socket Fusion, Metric (PROGEF Standard) (Available in USA/ASIA/EUROPE)

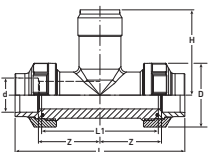
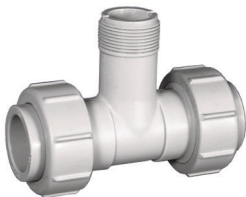

Part No.	FKM Code No.	EPDM Code No.	d [mm]	DN [mm]	PN	Sensor Type - Flow, pH/ORP	D [mm]	Z [mm]	L [mm]	L1 [mm]	H [mm]
PPMT005	727 310 036	727 310 006	20	15	10	Flow -X0, pH -XX	48	50	128	90	76
PPMT007	727 310 037	727 310 007	25	20	10	Flow -X0, pH -XX	58	55	142	100	78
PPMT010	727 310 038	727 310 008	32	25	10	Flow -X0, pH -XX	65	60	156	110	81
PPMT012	727 310 039	727 310 009	40	32	10	Flow -X0, pH -XX	79	60	160	110	85
PPMT015	727 310 040	727 310 010	50	40	10	Flow -X0, pH -XX	91	65	176	120	89
PPMT020	727 310 041	727 310 011	63	50	10	Flow -X0, pH -XX	105	70	194	130	95

- For use with Flow: P51530-X0, 3-2536-X0, 3-8510-X0, 3-8512-X0, 3-2537-XC-X0, 3-2551-X0-XX
- For use with pH/ORP: 3-272X-XX, 3-273X-XX
- To install this installation fitting in PVC-C, PP-R and PE pipes; replace the original union ends with PVC-C, PP-R and PE union ends.
- Threaded outlet 1 1/4 inch NPSM
- Union end with fusion socket PP-H

# Installation Fittings

## PVDF for Socket Fusion, Metric, Type 310 (SYGEF Standard) (Available in USA/ASIA/EUROPE)

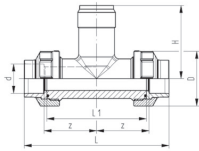

Part No.	FKM Code No.	d [mm]	Sensor Type - Flow, pH/ORP	PN [Bar]	D [mm]	H [mm]	L [mm]	L1 [mm]	z [mm]
SFMT005	735 310 036	20	Flow -X0, pH -XX	16	45	76	128	90	50
SFMT007	735 310 037	25	Flow -X0, pH -XX	16	55	78	142	100	55
SFMT010	735 310 038	32	Flow -X0, pH -XX	16	62	81	156	110	60
SFMT012	735 310 039	40	Flow -X0, pH -XX	16	75	85	160	110	60
SFMT015	735 310 040	50	Flow -X0, pH -XX	16	84	89	176	120	65
SFMT020	735 310 041	63	Flow -X0, pH -XX	16	101	95	194	130	70

- For use with Flow: P51530-X0, 3-2536-X0, 3-8510-X0, 3-8512-X0, 3-2537-XC-X0, 3-2551-X0-XX
- For use with pH/ORP: 3-272X-XX, 3-273X-XX
- To install this installation fitting in PVC-C, PP-R and PE pipes; replace the original union ends with PVC-C, PP-R and PE union ends
- Socket fusion equipment is required to install PVDF union tees
- FKM O-rings
- Sensor length depends on installation fitting
- Threaded outlet 1 1/4 inch NPSM

## Carbon Steel Threaded Tees with NPT Threads (Available in USA/ASIA)

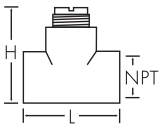

Part No.	Code No.	Size [in.]	Sensor Type - Flow, pH/ORP	L [in.]	H [in.]
CS4T005	198 801 459	0.50	Flow -X0, pH -XX	3.6	4.0
CS4T007	198 801 460	0.75	Flow -X0, pH -XX	3.6	4.2
CS4T010	198 801 461	1.00	Flow -X0, pH -XX	3.6	4.2
CS4T012	198 801 462	1.25	Flow -X0, pH -XX	3.8	4.5
CS4T015	198 801 419	1.50	Flow -X0, pH -XX	4.1	4.8
CS4T020	198 801 463	2.00	Flow -X0, pH -XX	4.9	5.3

- For use with Flow: P51530-X0, 3-2536-X0, 3-8510-X0, 3-8512-X0, 3-2537-XC-X0, 3-2551-X0-XX,
- For use with pH/ORP: 3-272X-XX, 3-273X-XX
- PVDF insert - all sizes
- For use with SCH 40 metal pipe (ASTM)
- PTFE wetted material. Contact factory for available options

## Copper Sweat-on Tee with PVDF Insert (Available in USA/ASIA)

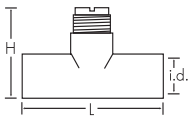

Part No.	Code No.	Size [in.]	Sensor Type - Flow, pH/ORP	L [in.]	H [in.]	i.d. [in.]
CUKT005	198 801 687	0.50	Flow -X0, pH -XX	3.15	3.30	0.62
CUKT007	198 801 688	0.75	Flow -X0, pH -XX	2.96	3.52	0.87
CUKT010	198 801 689	1.00	Flow -X0, pH -XX	3.00	3.80	1.12
CUKT012	198 801 690	1.25	Flow -X0, pH -XX	4.16	4.12	1.38
CUKT015	198 801 691	1.50	Flow -X0, pH -XX	4.50	4.34	1.63
CUKT020	198 801 418	2.00	Flow -X0, pH -XX	5.50	4.86	2.11

- For use with Flow: P51530-X0, 3-2536-X0, 3-8510-X0, 3-8512-X0, 3-2537-XC-X0, 3-2551-X0-XX
- For use with pH/ORP: 3-272X-XX, 3-273X-XX
- No insert up to 1 in., over 1 in. - PVDF insert
- For use with copper pipe (SCH K)
- PTFE wetted material. Contact factory for available options

## Galvanized Iron Threaded Tee with NPT Threads and PVDF Insert (Available in USA/ASIA)

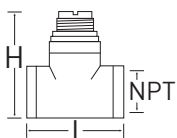

Part No.	Code No.	Size [in.]	Sensor Type - Flow, pH/ORP	NPT	L [in.]	H [in.]
IR4T010	198 801 421	1.00	Flow -X0, pH -XX	1.00	3.4	4.1
IR4T012	198 801 422	1.25	Flow -X0, pH -XX	1.25	3.56	4.34
IR4T015	198 801 423	1.50	Flow -X0, pH -XX	1.50	3.75	4.67
IR4T020	198 801 424	2.00	Flow -X0, pH -XX	2.00	3.90	5.05

- For use with Flow: P51530-X0, 3-2536-X0, 3-8510-X0, 3-8512-X0, 3-2537-XC-X0, 3-2551-X0-XX
- For use with pH/ORP: 3-272X-XX, 3-273X-XX
- PVDF insert - all sizes
- For use with SCH 40 metal pipe (ASTM)
- PTFE wetted material. Contact factory for available options

# Installation Fittings



0.50" - 1.00"



1.25" - 2.00"

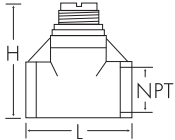

## 316 SS (1.4401) Threaded Tees with NPT Threads with PVDF Insert (Available in USA/ASIA)

Part No.	Code No.	Size [in.]	Sensor Type - Flow, pH/ORP	L [in.]	H [in.]
CR4T005	198 801 554	0.50	Flow -X0, pH -XX	3.6	4.0
CR4T007	198 801 555	0.75	Flow -X0, pH -XX	3.6	4.2
CR4T010	198 801 556	1.00	Flow -X0, pH -XX	3.6	4.2
CR4T012	198 801 783	1.25	Flow -X0, pH -XX	3.8	4.5
CR4T015	198 801 784	1.50	Flow -X0, pH -XX	4.1	4.8
CR4T020	198 801 785	2.00	Flow -X0, pH -XX	4.9	5.3

- For use with Flow: P51530-X0, 3-2536-X0, 3-8510-X0, 3-8512-X0, 3-2537-XC-X0, 3-2551-X0-XX
- For use with pH/ORP: 3-272X-XX, 3-273X-XX
- PVDF insert - all sizes
- For use with SCH 40 metal pipe (ASTM)
- PTFE wetted material. Contact factory for available options

## Brass Threaded Tee with NPT Threads and PVDF Insert (Available in USA/ASIA)

Part No.	Code No.	Size [in.]	Sensor Type - Flow, pH/ORP	NPT [in.]	L [in.]	H [in.]
BR4T010	198 801 770	1.00	Flow -X0, pH -XX	1.00	3.36	4.09
BR4T012	198 801 771	1.25	Flow -X0, pH -XX	1.25	3.42	4.42
BR4T015	198 801 772	1.50	Flow -X0, pH -XX	1.50	3.46	4.70
BR4T020	198 801 773	2.00	Flow -X0, pH -XX	2.00	3.68	5.19

- For use with Flow: P51530-X0, 3-2536-X0, 3-8510-X0, 3-8512-X0, 3-2537-XC-X0, 3-2551-X0-XX
- For use with pH/ORP: 3-272X-XX, 3-273X-XX
- PVDF insert - all sizes
- For use with SCH 40 metal pipe (ASTM)
- PTFE wetted material. Contact factory for available options

## Carbon Steel Weld-on Weldolets for use with SCH 40 Metal Pipe (ASTM) (Available in USA/ASIA)

Part No.	Code No.	Size [in.]	Sensor Type - Flow, pH/ORP	W [in.]	H [in.]	C [in.]
CS4W025	198 801 464	2.50	Flow -X0, pH -XX	2.60	2.48	1.31
CS4W030	198 801 557	3.00	Flow -X0, pH -XX	2.60	2.47	1.31
CS4W040	198 801 552	4.00	Flow -X0, pH -XX	2.60	2.45	1.31
CS4W050	198 801 465	5.00	Flow -X1	3.50	3.24	2.10
CS4W060	198 801 553	6.00	Flow -X1	3.50	3.11	2.10
CS4W080	198 801 574	8.00	Flow -X1	3.50	2.88	2.10
CS4W100	198 801 575	10.0	Flow -X2	3.50	5.63	2.10
CS4W120	198 801 576	12.0	Flow -X2	3.50	5.40	2.10

- For use with Flow: P51530-X0/-X1/-X2, 3-2536-X0/-X1/-X2, 3-8510-X0/-X1, 3-8512-X0/-X1, 3-2537-XC-X0/-X1, 3-2551-X0-XX/-X1-XX/-X2-XX
- For use with pH/ORP: 3-272X-XX, 3-273X-XX
- C - Clearance dimension
- Up to 8 in. - PVDF insert, over 8 in. - PVC insert
- PTFE wetted material. Contact factory for available options

## Brass Brazolet with PVDF Insert for use with Copper Pipe (SCH 40 ASTM) (Available in USA/ASIA)

Part No.	Code No.	Size [in.]	Sensor Type - Flow, pH/ORP	W [in.]	H [in.]	C [in.]
BR4B025	198 801 794	2.50	Flow -X0, pH -XX	2.50	2.48	1.31
BR4B030	198 801 795	3.00	Flow -X0, pH -XX	2.50	2.47	1.31
BR4B040	198 801 796	4.00	Flow -X0, pH -XX	2.50	2.45	1.31
BR4B050	198 801 797	5.00	Flow -X1	3.50	3.24	2.10
BR4B060	198 801 798	6.00	Flow -X1	3.50	3.11	2.10
BR4B080	198 801 799	8.00	Flow -X1	3.50	2.88	2.10
BR4B100	198 801 800	10.0	Flow -X2	3.50	5.63	2.10
BR4B120	198 801 801	12.0	Flow -X2	3.50	5.40	2.10

- For use with Flow: P51530-X0/-X1/-X2, 3-2536-X0/-X1/-X2, 3-8510-X0/-X1, 3-8512-X0/-X1, 3-2537-XC-X0/-X1, 3-2551-X0-XX/-X1-XX/-X2-XX
- For use with pH/ORP: 3-272X-XX, 3-273X-XX
- C - Clearance dimension
- Up to 8 in. - PVDF insert, over 8 in. - PVC insert
- PTFE wetted material. Contact factory for available options

Multi-Parameter Instruments

Communication Protocol

Chlorine

Dissolved Oxygen

Flow

pH/ORP

Conductivity/Resistivity

Level

Temperature

Pressure

Other Products

Installation & Wiring

Technical Reference

Temperature/Pressure Graphs

# Installation Fittings

## 316 SS (1.4401) Weldolets with PVDF Insert for use with SCH 40 Metal Pipe (ASTM) (Available in USA/ASIA)

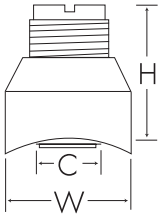

Part No.	Code No.	Size [in.]	Sensor Type - Flow, pH/ORP	W [in.]	H [in.]	C [in.]
CR4W025	198 801 786	2.50	Flow -X0, pH -XX	2.50	2.48	1.31
CR4W030	198 801 787	3.00	Flow -X0, pH -XX	2.50	2.47	1.31
CR4W040	198 801 788	4.00	Flow -X0, pH -XX	2.50	2.45	1.31
CR4W050	198 801 789	5.00	Flow -X1	3.50	3.24	2.10
CR4W060	198 801 790	6.00	Flow -X1	3.50	3.11	2.10
CR4W080	198 801 791	8.00	Flow -X1	3.50	2.88	2.10
CR4W100	198 801 792	10.0	Flow -X2	3.50	5.63	2.10
CR4W120	198 801 793	12.0	Flow -X2	3.50	5.40	2.10

- For use with Flow: P51530-X0/-X1/-X2, 3-2536-X0/-X1/-X2, 3-8510-X0/-X1, 3-8512-X0/-X1, 3-2537-XC-X0/-X1, 3-2551-X0-XX/-X1-XX/-X2-XX
- For use with pH/ORP: 3-272X-XX, 3-273X-XX
- Up to 8 in. - PVDF insert, over 8 in. - PVC insert
- C - Clearance dimension
- PTFE wetted material. Contact factory for available options

## Iron Strap-on Saddle for use with SCH 80 Metal Pipe (ASTM) (Available in USA/ASIA)

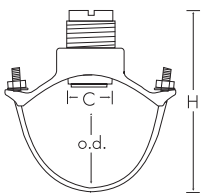

Part No.	Code No.	Size [in.]	Sensor Type - Flow, pH/ORP	H [in.]	o.d. min [in.]	o.d. max [in.]	C [in.]
IR8S020	198 801 425	2.00	Flow -X0, pH -XX	5.5	2.35	2.56	1.44
IR8S025	198 801 426	2.50	Flow -X0, pH -XX	5.5	2.44	2.91	1.44
IR8S030	198 801 427	3.00	Flow -X0, pH -XX	6.5	2.97	3.54	1.44
IR8S040	198 801 420	4.00	Flow -X0, pH -XX	7.5	4.40	4.55	1.44
IR8S050	198 801 429	5.00	Flow -X1	9.0	5.00	5.63	2.25
IR8S060	198 801 430	6.00	Flow -X1	10.5	5.94	6.70	2.25
IR8S080	198 801 431	8.00	Flow -X1	12.0	7.69	8.72	2.25
IR8S100	198 801 432	10.0	Flow -X2	18.0	10.64	12.12	2.25
IR8S120	198 801 433	12.0	Flow -X2	20.0	12.62	14.32	2.25

- For use with Flow: P51530-X0/-X1/-X2, 3-2536-X0/-X1/-X2, 3-8510-X0/-X1, 3-8512-X0/-X1, 3-2537-XC-X0/-X1, 3-2551-X0-XX/-X1-XX/-X2-XX
- For use with pH/ORP: 3-272X-XX, 3-273X-XX
- C - Clearance dimension
- Up to 8 in. - PVDF insert, over 8 in. - PVC insert
- Buna O-ring
- Larger sizes may be available as well as PTFE wetted material. Contact factory

## Fiberglass Glue-on Tees (Available in USA/ASIA)

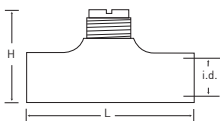

Part No.	Code No.	Size [in.]	Sensor Type - Flow, pH/ORP	L [in.]	H [in.]	i.d. [in.]
FPT015	159 000 446	1.50	Flow -X0, pH -XX	5.5	4.7	1.92
FPT020	159 000 447	2.00	Flow -X0, pH -XX	7.7	8.0	2.38

- For use with Flow: P51530-X0, 3-2536-X0, 3-8510-X0, 3-8512-X0, 3-2537-XC-X0, 3-2551-X0-XX,
- For use with pH/ORP: 3-272X-XX, 3-273X-XX
- PVDF insert - all sizes
- PTFE wetted material. Contact factory for available options

# Installation Fittings

## JIS PVC-U Tee Fittings (Available in ASIA)

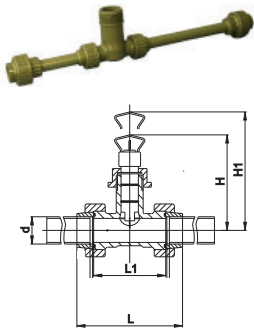

EPDM Code No.	FKM Code No.	DN [mm]	Sensor Type - Flow, pH/ORP	d [mm]	H [mm]	H1 [mm]	L [mm]	L1 [mm]
200 072 063	200 070 933	15	Flow -X0, pH -XX	22	145	225	128	90
200 072 064	200 070 934	20	Flow -X0, pH -XX	26	148	228	144	100
200 072 065	200 070 935	25	Flow -X0, pH -XX	32	151	231	160	110
200 072 066	200 070 936	32	Flow -X0, pH -XX	38	155	235	168	110
200 072 067	200 070 937	40	Flow -X0, pH -XX	48	159	239	188	120
200 072 068	200 070 902	50	Flow -X0, pH -XX	60	164	244	212	130

- For use with Flow: P51530-X0, 3-2536-X0, 3-8510-X0, 3-8512-X0, 3-2537-XC-X0, 3-2551-X0-XX,
- For use with pH/ORP: 3-272X-XX, 3-273X-XX
- These fittings are only available from the Georg Fischer sales office in Japan
- Choice FKM or EPR (EPDM) O-ring
- Appearance varies in DN15 mm

## JIS PVC-U Tee Fittings (Flange Type) (Available in ASIA)

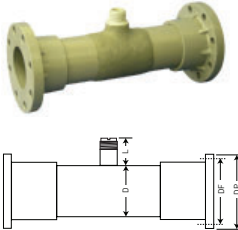

Code No.	DN [mm]	Sensor Type - Flow, pH/ORP	D [mm]	DF	DP	L [mm]
200 070 892	65	Flow -X0, pH -XX	76	175	140	57.2
200 070 893	80	Flow -X0, pH -XX	89	185	150	56.8
200 070 894	100	Flow -X0, pH -X1	114	210	175	56.9
200 070 895	125	Flow -X1	140	250	210	82.0
200 070 896	150	Flow -X1	165	280	240	77.8
200 070 897	200	Flow -X1	216	330	290	71.6

- For use with Flow: with P51530-X0/-X1, 3-2536-X0/-X1, 3-8510-X0/-X1, 3-8512-X0/-X1, 3-2537-XC-X0/-X1, 3-2551-X0-XX/-X1-XX
- For use with pH/ORP: 3-272X-XX, 3-273X-XX
- These fittings are only available from the Georg Fischer sales office in Japan

Multi-Parameter Instruments

Communication Protocol

Chlorine

Dissolved Oxygen

Flow

pH/ORP

Conductivity/Resistivity

Level

Temperature

Pressure

Other Products

Installation & Wiring

Technical Reference

Temperature/Pressure Graphs



# Installation Fittings

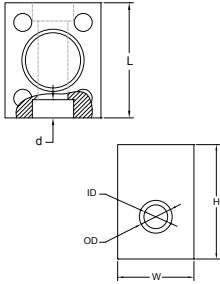
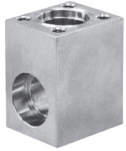

**Metalex Socket Weld Mini-Tap (1.4401) (Available in USA/ASIA/EUROPE)**

Part No.	Code No.	DN [mm]	Size [in.]	Sensor Type - Flow	o.d [mm]	d [mm]	i.d. [mm]	o.d. [in.]	d [in.]	i.d. [in.]	L [in.]	W [in.]	H [in.]
P526-2005	198 840 501	15	0.50	P525-1, -1S	21.8	9.7	15.8	0.85	0.38	0.622	2.4	2.0	3.0
P526-2007	198 840 502	20	0.75	P525-1, -1S	27.2	12.7	20.9	1.06	0.50	0.824	2.4	2.0	3.0
P526-2010	198 840 503	25	1.00	P525-1, -1S	33.8	12.7	26.7	1.33	0.50	1.05	2.4	2.0	3.0

- For use with P525-1 and P525-1S only
- For use with SS pipe

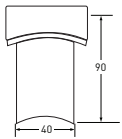

**SS Weld-On Fittings (1.4401) (Available in USA/ASIA/EUROPE)**

Code No.	DN [mm]	Inch
198 150 346	40 - 800	1.50 - 30

- For use with P525-2 and P525-2S

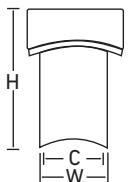

**Metalex Weld-on Mini-Tap (1.4401) (Available in USA/ASIA/EUROPE)**

Part No.	Code No.	Size [in.]	Sensor Type - Flow	W [in.]	H [in.]	C [in.]
P526-2012	159 000 494	1.25	P525-2, -2S	1.66	2.25	1.26
P526-2015	198 840 506	1.50	P525-2, -2S	1.66	2.20	1.26
P526-2020	159 000 495	2.00	P525-2, -2S	1.66	2.17	1.26
P526-2025	159 000 496	2.50	P525-2, -2S	1.66	2.10	1.26
P526-2030	159 000 497	3.00	P525-2, -2S	1.66	2.00	1.26
P526-2040	159 000 498	4.00	P525-2, -2S	1.66	1.95	1.26
P526-2050	159 000 499	5.00	P525-2, -2S	1.66	1.83	1.26
P526-2060	159 000 500	6.00	P525-2, -2S	1.66	1.75	1.26
P526-2080	159 000 501	8.00	P525-2, -2S	1.66	1.56	1.26
P526-2100	159 000 502	10.00	P525-2, -2S	1.66	1.35	1.26
P526-2120	159 000 503	12.00	P525-2, -2S	1.66	1.15	1.26

- For use with P525-2 and P525-2S only
- For use with SS pipe
- Gasket Klingner C4401 Thermoseal

# Installation Fittings

## Electrofusion for PE pipes: Transition Saddles with Stainless 1/4 Inch Outlet (Available in USA/ASIA)



Code No.	Size [in.]	Sensor Type - Flow, pH/ORP	L [in.]	H [in.]	d [in.]
10004673	2.0	2552-2	3.6	3.18	N/A
10004686	3.0	2552-2	4.6	3.18	N/A
10004700	4.0	2552-2	6.26	3.8	N/A
10004717	6.0	2552-2	8.68	4.96	N/A
10007761	8.0	2552-2	5.92	2.96	N/A
Special request	10.0	2552-2	Call	Call	N/A
Special request	12.0	2552-2	Call	Call	N/A



### 1 1/2 Inch Outlet

10004676	2.0	2552-3, 2540-XX, 3719-11	3.6	3.18	N/A
10004689	3.0	2552-3, 2540-XX, 3719-11	4.6	3.18	N/A
10004703	4.0	2552-3, 2540-XX, 3719-11	6.26	3.8	N/A
10004720	6.0	2552-3, 2540-XX, 3719-11	8.68	4.96	N/A
10004743	8.0	2552-3, 2540-XX, 3719-11	5.92	2.96	N/A
Special request	10.0	2552-3, 2540-XX, 3719-11	Call	Call	N/A
Special request	12.0	2552-3, 2540-XX, 3719-11	Call	Call	N/A

- Transition saddle with 1/4 FNPT branch/outlet
- Transition saddle with 1/2 FNPT branch/outlet
- These fittings are only available from your local Georg Fischer sales office

## Type 312 PE Electrofusion System (Available in EUROPE)

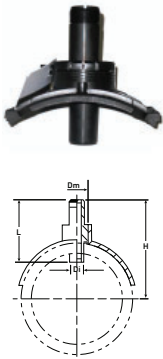

Code No.	d [mm]	PN [bar]	Sensor Type - Flow	Di [mm]	H [mm]	L [mm]	Dm [mm]
753 312 012	75	16	Flow -X1	38	123	102	63
753 312 013	90	16	Flow -X1	38	130	102	63
753 312 014	110	16	Flow -X1	38	142	102	63
753 312 015	125	16	Flow -X1	38	141	102	63
753 312 016	140	16	Flow -X1	38	146	102	63
753 312 017	160	16	Flow -X1	38	153	102	63
753 312 018	180	16	Flow -X2	38	235	178	63
753 312 019	200	16	Flow -X2	38	244	178	63
753 312 020	225	16	Flow -X2	38	250	178	63
753 312 021	250	16	Flow -X2	38	258	178	63
753 312 022	280	16	Flow -X2	38	268	178	63
753 312 023	315	16	Flow -X2	38	279	178	63
753 312 024	355	16	Flow -X2	38	293	178	63
753 312 025	400	16	Flow -X2	38	307	178	63

- For use with Flow: P51530-X1/-X2, 3-2536-X1/-X2, 3-8510-X1, 3-8512-X1, 3-2537-XC-X1, 3-2551-X1-XX
- Sensor length depends on installation fitting
- Threaded outlet 1/4 inch NPSM
- Material: Polyethylene

# Installation Fittings

## Type 310, PVC-U for Socket Systems, Metric (Available in EUROPE)

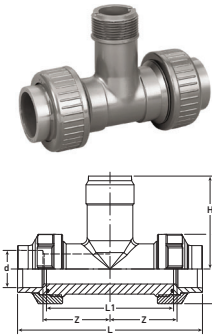

EPDM Code No.	FKM Code No.	d [mm]	DN [mm]	PN [bar]	Sensor Type - Flow, pH/ORP	D [mm]	L [mm]	L1 [mm]	H [mm]	z [mm]
721 310 006	721 310 036	20	15	16	Flow -X0, pH -XX	43	128	90	76	48
721 310 007	721 310 037	25	20	16	Flow -X0, pH -XX	51	144	100	78	53
721 310 008	721 310 038	32	25	16	Flow -X0, pH -XX	58	160	110	81	58
721 310 009	721 310 039	40	32	16	Flow -X0, pH -XX	72	168	110	85	58
721 310 010	721 310 040	50	40	16	Flow -X0, pH -XX	83	188	120	89	63
721 310 011	721 310 041	63	50	16	Flow -X0, pH -XX	100	212	130	95	68

- For use with Flow: P51530-X0, 3-2536-X0, 3-8510-X0, 3-8512-X0, 3-2537-XC-X0, 3-2551-X0-XX
- For use with pH/ORP: 3-272X-XX, 3-273X-XX
- Sensor length depends on installation fitting
- Threaded outlet 1 1/4 inch NPSM
- To install this installation fitting in PVC-C, PP-R and PE pipes; replace the original union ends with PVC-C, PP-R and PE union ends

## Type 314, PVC-U, Weldolet, Metric (Available in EUROPE)

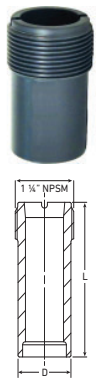

Code No.	d [mm]	DN [mm]	Sensor Type - Flow, pH/ORP	D [mm]	L [mm]
721 314 000	75 - 180	65 - 150	Flow -X0, pH - XX	38	68
721 314 001	200 - 355	200 - 350	Flow -X1	38	102
721 314 002	400 - 630	350 - 600	Flow -X2	38	178

- For use with Flow: P51530-X0/-X1/-X2, 3-2536-X0/-X1/-X2, 3-8510-X0/-X1, 3-8512-X0/-X1, 3-2537-XC-X0/-X1, 3-2551-X0-XX/-X1-XX/-X2-XX
- For use with pH/ORP: 272X-XX, 3-273X-XX
- Sensor length depends on installation fitting
- Threaded outlet 1 1/4 inch NPSM
- Please consult the instruction manual
- For conventional hot gas back welding according to DVS 2207 part 3
- Your maximum allowable pressure may be determined by the pressure rating of the pipe material, quality of weld and/or installed sensor
- pH sensors can also be used for dimensions above d180/DN150 and below d75/DN65 with 721 314 000 the length might have to be adjusted

## Type 312, PVC-U, Glue-on Saddle, Metric (Available in EUROPE)

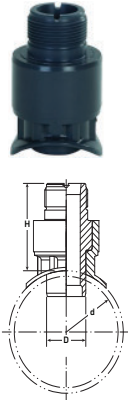

Code No.	d [mm]	DN [mm]	PN [bar]	Sensor Type - Flow	D [mm]	H [mm]
721 312 012	75	65	10	Flow -X1	38	89
721 312 013	90	80	10	Flow -X1	38	89
721 312 014	110	100	10	Flow -X1	38	89
721 312 015	125	100	10	Flow -X1	38	81
721 312 016	140	125	10	Flow -X1	38	79
721 312 017	160	150	10	Flow -X1	38	76
721 312 019	200	200	10	Flow -X1	38	69
721 312 020	225	200	10	Flow -X2	38	141
721 312 021	250	250	10	Flow -X2	38	137
721 312 023	315	300	10	Flow -X2	38	127

- For use with Flow: P51530-X1/-X2, 3-2536-X1/-X2, 3-8510-X1, 3-8512-X1, 3-2537-XC-X1, 3-2551-X1-XX
- Sensor length depends on installation fitting
- Threaded outlet 1 1/4 inch NPSM
- Top saddle for solvent cement bonding

## Type 312, PVC-U Clamp-on Saddle, Metric (Available in EUROPE)

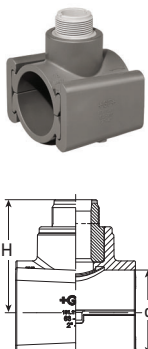

Code No.	d [mm]	DN [mm]	PN [bar]	Sensor Type - Flow, pH/ORP	H [mm]	L [mm]
198 150 538	75	65	16	Flow -X0, pH-XX	99	105
198 150 539	90	80	16	Flow -X0, pH-XX	105	105
198 150 540	110	100	16	Flow -X0, pH-XX	114	105
198 150 543	160	150	16	Flow -X1	157	120
198 150 545	225	200	16	Flow -X1	184	120

- For use with Flow: P51530-X0/-X1, 3-2536-X0/-X1, 3-8510-X0/-X1, 3-8512-X0/-X1, 3-2537-XC-X0/-X1, 3-2551-X0-XX/-X1-XX
- For use with pH/ORP: 3-272X-XX, 3-273X-XX
- Sensor length depends on installation fitting
- Threaded outlet 1 1/4 inch NPSM
- Top saddle for solvent cement bonding
- Seal: Lip seal of EPDM
- pH sensors can only be used up to 4 in. or DN100 pipe

Alternative solution can be a PP saddle or wafer. Pipe size, pressure rating and chemical resistance need to be evaluated.

# Installation Fittings

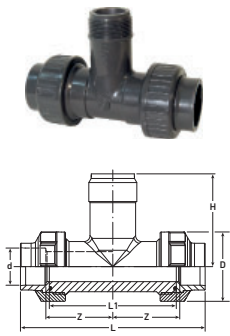

**Type 310, BSP PVC-U for Socket Fusion, BS Inch (Available in EUROPE)**

EPDM Code No.	FKM Code No.	d [in.]	PN [bar]	Sensor Type - Flow, pH/ORP	D [mm]	z [mm]	L [mm]	L1 [mm]	H [mm]
721 310 306	721 310 336	½	15	Flow -X0, pH -XX	43	48	131	90	76
721 310 307	721 310 337	¾	15	Flow -X0, pH -XX	51	53	147	100	78
721 310 308	721 310 338	1	15	Flow -X0, pH -XX	58	58	164	110	81
721 310 309	721 310 339	1¼	15	Flow -X0, pH -XX	72	58	171	110	85
721 310 310	721 310 340	1½	15	Flow -X0, pH -XX	83	63	188	120	89
721 310 311	721 310 341	2	15	Flow -X0, pH -XX	100	68	211	130	95

- For use with Flow: P51530-X0, 3-2536-X0, 3-8510-X0, 3-8512-X0, 3-2537-XC-X0, 3-2551-X0-XX
- For use with pH/ORP: 3-272X-XX, 3-273X-XX
- Sensor length depends on installation fitting
- BSP - British Standard Pipe
- Threaded outlet 1¼ inch NPSM

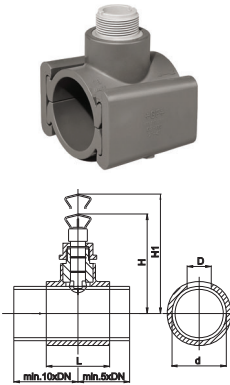

**Type 312, BSP PVC-U, Clamp-on Saddle, BS Inch (Available in EUROPE)**

Code No.	d [mm]	d [in.]	DN [mm]	PN [bar]	Sensor Type - Flow, pH/ORP	D [mm]	H [mm]	H1 [mm]	L [mm]
198 150 550	90	3	80	15	Flow -X0, pH -XX	39	105	225	105
198 150 551	110	4	100	15	Flow -X0, pH -XX	39	114	264	105
198 150 554	160	6	150	15	Flow -X1	39	156	339	120

- For use with Flow: P51530-X0/-X1, 3-2536-X0/-X1, 3-8510-X0/-X1, 3-8512-X0/-X1, 3-2537-XC-X0/-X1, 3-2551-X0-XX/-X1-XX
- For use with pH/ORP: 3-272X-XX, 3-273X-XX
- Sensor length depends on installation fitting
- BSP - British Standard Pipe
- Threaded outlet 1¼ inch NPSM
- Lip seal EPDM
- Alternative solution can be a PP saddle or wafer pipe size, pressure rating and chemical resistance need to be evaluated

**Type 310, PVC-C for Socket Systems, Metric (Available in EUROPE)**

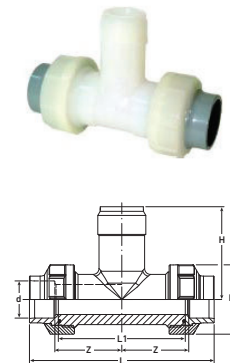

EPDM Code No.	FKM Code No.	d [mm]	DN [mm]	PN [bar]	Sensor Type - Flow, pH/ORP	D [mm]	z [mm]	L [mm]	L1 [mm]	H [mm]
723 310 006	723 310 036	20	15	16	Flow -X0, pH -XX	45	49	132	90	76
723 310 007	723 310 037	25	20	16	Flow -X0, pH -XX	55	53	148	100	78
723 310 008	723 310 038	32	25	16	Flow -X0, pH -XX	62	58	164	110	81
723 310 009	723 310 039	40	32	16	Flow -X0, pH -XX	75	58	172	110	85
723 310 010	723 310 040	50	40	16	Flow -X0, pH -XX	84	63	188	120	89
723 310 011	723 310 041	63	50	16	Flow -X0, pH -XX	101	68	212	130	95

- For use with Flow: P51530-X0, 3-2536-X0, 3-8510-X0, 3-8512-X0, 3-2537-XC-X0, 3-2551-X0-X0-XX
- For use with pH/ORP: 3-272X-XX, 3-273X-XX
- Sensor length depends on installation fitting
- Threaded outlet 1¼ inch NPSM
- Body and union nut PVDF
- Union end with solvent cement socket PVC-C

Multi-Parameter Instruments

Communication Protocol

Chlorine

Dissolved Oxygen

Flow

pH/ORP

Conductivity/Resistivity

Level

Temperature

Pressure

Other Products

Installation & Wiring

Technical Reference

Temperature/Pressure Graphs

# Installation Fittings

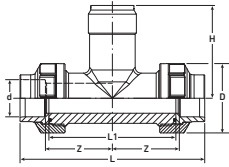

**Type 310, PROGEF Standard, PP-H for Socket Fusion, Metric (Available in EUROPE)**

EPDM Code No.	FKM Code No.	d [mm]	DN [mm]	PN [bar]	Sensor Type - Flow, pH/ORP	D [mm]	Z [mm]	L [mm]	L1 [mm]	H [mm]
727 310 006	727 310 036	20	15	10	Flow -X0, pH -XX	48	50	128	90	76
727 310 007	727 310 037	25	20	10	Flow -X0, pH -XX	58	55	142	100	78
727 310 008	727 310 038	32	25	10	Flow -X0, pH -XX	65	60	156	110	81
727 310 009	727 310 039	40	32	10	Flow -X0, pH -XX	79	60	160	110	85
727 310 010	727 310 040	50	40	10	Flow -X0, pH -XX	91	65	176	120	89
727 310 011	727 310 041	63	50	10	Flow -X0, pH -XX	105	70	194	130	95

- For use with Flow: P51530-X0, 3-2536-X0, 3-8510-X0, 3-8512-X0, 3-2537-XC-X0, 3-2551-X0-XX
- For use with pH/ORP: 3-272X-XX, 3-273X-XX

- To install this installation fitting in PVC-C, PP-R and PE pipes; replace the original union ends with PVC-C, PP-R and PE union ends
- Threaded outlet 1 1/4 inch NPSM
- Union end with socket fusion PP-H

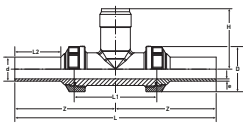

**Type 318, PROGEF Standard, PP-H for Butt Fusion, Metric (Available in EUROPE)**

EPDM Code No.	FKM Code No.	d [mm]	DN [mm]	PN [bar]	Sensor Type - Flow, pH/ORP	D [mm]	Z [mm]	L [mm]	L1 [mm]	L2 [mm]	H [mm]	e
727 318 006	727 318 036	20	15	10	Flow -X0, pH -XX	48	112	224	90	52	76	1.9
727 318 007	727 318 037	25	20	10	Flow -X0, pH -XX	58	121	242	100	53	78	2.3
727 318 008	727 318 038	32	25	10	Flow -X0, pH -XX	65	128	256	110	55	81	2.9
727 318 009	727 318 039	40	32	10	Flow -X0, pH -XX	79	136	272	110	60	85	3.7
727 318 010	727 318 040	50	40	10	Flow -X0, pH -XX	91	147	294	120	66	89	4.6
727 318 011	727 318 041	63	50	10	Flow -X0, pH -XX	105	158	316	130	70	95	5.8

- For use with Flow: P51530-X0, 3-2536-X0, 3-8510-X0, 3-8512-X0, 3-2537-X0, 3-2551-X0
- For use with pH/ORP: 3-272X-XX, 3-273X-XX
- Also available for PROGEF Natural Systems with union ends in PP-R and body in PP-H (Code No.: 728318106...) or with body in PVDF (Code No.: 728318006...)

- To install this installation fitting in PVC-C, PP-R and PE pipes; replace the original union ends with PVC-C, PP-R and PE union ends
- Threaded outlet 1 1/4 inch NPSM
- Union end with butt fusion spigot PP-H

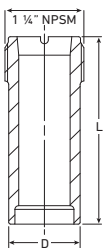

**Type 314, PROGEF Standard, PP-H, Metric (Available in EUROPE)**

Code No.	d [mm]	DN [mm]	Sensor Type - Flow, pH/ORP	D [mm]	L [mm]
727 314 000	75 - 180	65 - 150	Flow -X0, pH -XX	37.5	68
727 314 001	200 - 355	200 - 350	Flow -X1	37.5	102
727 314 002	400 - 630	350 - 600	Flow -X2	37.5	178

- For use with Flow: P51530-X0/-X1/-X2, 3-2536-X0/-X1/-X2, 3-8510-X0/-X1, 3-8512-X0/-X1, 3-2537-XC-X0/-X1, 3-2551-X0-XX/-X1-XX/-X2-XX
- For use with pH/ORP: 272X-XX, 3-273X-XX
- Threaded outlet 1 1/4 inch NPSM
- For conventional hot gas back welding according to DVS 2207 part 3

- Please consult the instruction manual
- Sensor length depends on installation fitting
- Your maximum allowable pressure may be determined by the pressure rating of the pipe material, quality of weld and/or installed sensor
- pH sensors can also be used for dimensions above d180/DN150 and below d75/DN65 with 727 314 000; the length might have to be adjusted

# Installation Fittings

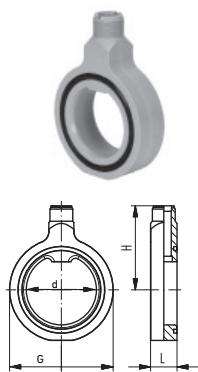

**Type 311, PROGEF Standard, PP-H, Wafer fitting, Metric/Inch (Available in EUROPE)**

EPDM Code No.	FKM Code No.	d [mm]	d [in.]	DN [mm]	PN [bar]	Sensor Type - Flow	D [mm]	H [mm]	L [mm]	L1 [mm]
727 311 012	727 311 042	75	2 ½	65	10	Flow -X1	88	133	48	61
727 311 013	727 311 043	90	3	80	10	Flow -X1	102	140	48	69
727 311 014	727 311 044	110	4	100	10	Flow -X1	132	145	48	79
727 311 015	727 311 045	125		100	10	Flow -X1	132	144	48	79
727 311 016	727 311 046	140	5	125	10	Flow -X1	157	149	48	94
727 311 017	727 311 047	160	6	150	10	Flow -X1	182	156	48	106
727 311 018	727 311 048	180		150	10	Flow -X1	182	163	48	106
727 311 019	727 311 049	200	8	200	10	Flow -X1	236	170	48	134
727 311 020	727 311 050	225	8	200	10	Flow -X1	236	178	48	134
727 311 021	727 311 051	250	10	250	10	Flow -X2	289	263	48	160
727 311 022	727 311 052	280	10	250	10	Flow -X2	289	273	48	160
727 311 023	727 311 053	315	12	300	10	Flow -X2	329	285	48	185

- For use with Flow: P51530-X1/-X2, 3-2536-X1/-X2, 3-8510-X1, 3-8512-X1, 3-2537-XC-X1, 3-2551-X1-XX
- Threaded outlet 1 ¼ inch NPSM
- Suitable for backing flanges metric and inch
- Suitable for SDR 11 - SDR 17.6
- Delivered with profile O-ring
- Wafer can be used with other pipe materials
- Sensor length depends on installation fitting

**Type 312, PP-H, Screw-on, Metric (Available in EUROPE)**

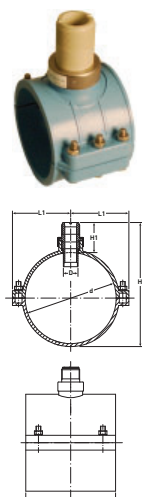

Code No.	d [mm]	DN [mm]	PN [bar]	Sensor Type - Flow	D [mm]	L [mm]	L1 [mm]	H [mm]	H1 [mm]
727 312 072	75	65	8	Flow -X1	34	78	62	172	88
727 312 073	90	80	8	Flow -X1	34	86	69	186	87
727 312 074	110	100	8	Flow -X1	34	98	79	206	86
727 312 075	125	100	8	Flow -X1	34	101	85	212	78
727 312 076	140	125	6	Flow -X1	34	114	104	227	75
727 312 077	160	150	6	Flow -X1	34	114	114	243	72
727 312 078	180	150	6	Flow -X2	34	168	134	348	144
727 312 079	200	200	6	Flow -X2	34	168	132	357	142
727 312 080	225	200	5	Flow -X2	34	174	146	375	136
727 312 081	250	250	5	Flow -X2	34	179	159	397	131
727 312 082	280	250	5	Flow -X2	34	179	167	426	127
727 312 083	315	300	5	Flow -X2	34	248	202	450	120

- For use with Flow: P51530-X1/-X2, 3-2536-X1/-X2, 3-8510-X1, 3-8512-X1, 3-2537-XC-X1, 3-2551-X1-XX
- Threaded outlet 1 ¼ inch NPSM
- Sensor length depends on installation fitting
- Top saddle with EPDM gasket
- Stainless steel bolts and nuts
- Saddle can be used with other pipe materials

Multi-Parameter Instruments  
 Communication Protocol  
 Chlorine  
 Dissolved Oxygen  
 Flow  
 pH/ORP  
 Conductivity/Resistivity  
 Level  
 Temperature  
 Pressure  
 Other Products  
 Installation & Wiring  
 Technical Reference  
 Temperature/Pressure Graphs

# Installation Fittings

## Poly16 Plus Clamp Saddle (Available in EUROPE)

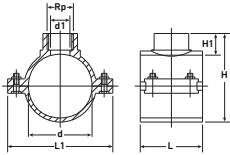

Code No.	d [mm]	Rp [in.]	PN [bar]	Sensor Type - Flow, pH/ORP, Conductivity	d1	H	H1	L	L1
727 627 012	25	3/4	16	pH/ORP 2724-X-1, 2726-X-1, 2774-ISO, 2777-ISO, Conductivity 2839-1D, 2842-1D	13	58	15	49	79
727 627 022	32	3/4	16	pH/ORP 2724-X-1, 2726-X-1, 2774-ISO, 2777-ISO, Conductivity 2839-1D, 2842-1D	14	62	20	49	79
727 627 032	40	3/4	16	pH/ORP 2724-X-1, 2726-X-1, 2774-ISO, 2777-ISO, Conductivity 2839-1D, 2842-1D	21	71	20	62	86
727 627 042	50	3/4	16	pH/ORP 2724-X-1, 2726-X-1, 2774-ISO, 2777-ISO, Conductivity 2839-1D, 2842-1D	21	82	20	62	86
727 627 044	50	1 1/4	16	Flow 2552-X2	21	82	20	62	86
727 627 052	63	3/4	16	pH/ORP 2724-X-1, 2726-X-1, 2774-ISO, 2777-ISO, Conductivity 2839-1D, 2842-1D	24	96	21	62	101
727 627 054	63	1 1/4	16	Flow 2552-X2	31	96	21	62	101
727 627 055	63	1 1/2	16	pH/ORP 3719-2, Flow 2540-21-4, 2552-X4	31	96	21	62	101
727 627 062	75	3/4	16	pH/ORP 2724-X-1, 2726-X-1, 2774-ISO, 2777-ISO, Conductivity 2839-1D, 2842-1D	21	104	16	79	123
727 627 064	75	1 1/4	16	Flow 2552-X2	35	109	21	79	123
727 627 065	75	1 1/2	16	pH/ORP 3719-2, Flow 2540-21-4, 2552-X4	42	109	21	79	123
727 627 072	90	3/4	16	pH/ORP 2724-X-1, 2726-X-1, 2774-ISO, 2777-ISO, Conductivity 2839-1D, 2842-1D	21	118	16	87	138
727 627 074	90	1 1/4	16	Flow 2552-X2	35	123	21	87	138
727 627 075	90	1 1/2	16	pH/ORP 3719-2, Flow 2540-21-4, 2552-X4	42	123	21	87	138
727 627 082	110	3/4	16	pH/ORP 2724-X-1, 2726-X-1, 2774-ISO, 2777-ISO, Conductivity 2839-1D, 2842-1D	20	150	23	99	152
727 627 084	110	1 1/4	16	Flow 2552-X2	35	150	23	99	152
727 627 085	110	1 1/2	16	pH/ORP 3719-2, Flow 2540-21-4, 2552-X4	41	150	23	99	152
727 627 092	125	3/4	16	pH/ORP 2724-X-1, 2726-X-1, 2774-ISO, 2777-ISO, Conductivity 2839-1D, 2842-1D	20	169	24	101	166
727 627 094	125	1 1/4	16	Flow 2552-X2	35	168	23	101	166
727 627 095	125	1 1/2	16	pH/ORP 3719-2, Flow 2540-21-4, 2552-X4	41	168	23	101	166
727 627 102	140	3/4	16	pH/ORP 2724-X-1, 2726-X-1, 2774-ISO, 2777-ISO, Conductivity 2839-1D, 2842-1D	24	191	25	114	207
727 627 104	140	1 1/4	16	Flow 2552-X2	38	191	25	114	207
727 627 105	140	1 1/2	16	pH/ORP 3719-2, Flow 2540-21-4, 2552-X4	45	191	24	114	207
727 627 112	160	3/4	16	pH/ORP 2724-X-1, 2726-X-1, 2774-ISO, 2777-ISO, Conductivity 2839-1D, 2842-1D	24	215	24	114	226
727 627 114	160	1 1/4	16	Flow 2552-X2	37	215	24	114	226
727 627 115	160	1 1/2	16	pH/ORP 3719-2, Flow 2540-21-4, 2552-X4	45	215	24	114	226
727 627 124	180	1 1/4	10	Flow 2552-X2	36	265	38	169	262
727 627 125	180	1 1/2	10	pH/ORP 3719-2, Flow 2540-21-4, 2552-X4	42	265	38	169	262
727 627 145	225	1 1/2	10	pH/ORP 3719-2, Flow 2540-21-4, 2552-X4	45	287	26	174	287

- Stainless steel bolts
- Saddle can be used with other pipe materials

- Check H1 value vs. sensor length regarding minimum insertion depth.

# Installation Fittings

## Adapter Socket, PP-H, ANSI - NPT (Available in EUROPE)

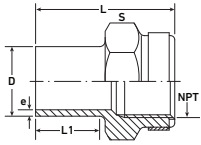

Code No.	d [mm]	NPT [in.]	PN [bar]	Sensor Type - Flow, pH/ORP, Conductivity, Temperature, Pressure	D [mm]	L [mm]	L1 [mm]	s [mm]	e [mm]
727 914 357	25	¾	10	2724-2726, 2774-2777, 2819-2842, 2350, 2450	25	51	23	36	2.3
727 914 358	32	1	10	2764-2767	32	54	23	46	2.9
727 914 359	40	1¼	10	2552-X1	40	56	23	55	3.7
727 914 360	50	1½	10	3719-11, 2540-1/-3, 2552-X3	50	60	23	65	4.6
727 914 361	63	2	10	3719-21	63	62	23	80	5.8

- "d" is for pipe dimension
- Connection via Butt or IR fusion
- Check L1 value vs. sensor length regarding minimum insertion depth

## Adapter Socket, PP-H, Metric - Rp (Available in EUROPE)

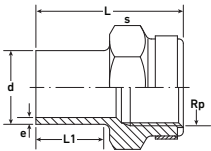

Code No.	d [mm]	Rp [in.]	PN [bar]	Sensor Type - Flow, pH/ORP, Conductivity	L [mm]	L1 [mm]	s [mm]	e [mm]
727 910 267	25	¾	10	2724-X1, 2726-X1, 2774-ISO, 2777-ISO, 2839-1D-2842-1D	50	23	36	2.3
727 910 269	40	1¼	10	2552-X2	56	23	55	3.7
727 910 270	50	1½	10	3719-12, 2540-2/-4, 2552-X4	60	23	65	4.6
727 910 271	63	2	10	3719-22	62	23	80	5.8

- "d" is for pipe dimension
- Connection via Butt or IR fusion
- Check L1 value vs. sensor length regarding minimum insertion depth

## Type 318, ecoFIT PE100 SDR 11 for Butt Fusion System, Metric (Available in EUROPE)

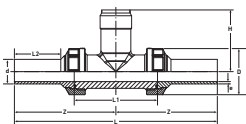

EPDM Code No.	FKM Code No.	d [mm]	DN [mm]	PN [bar]	Sensor Type - Flow, pH/ORP	D [mm]	L [mm]	L1 [mm]	L2 [mm]	H [mm]	z
753 318 006	753 318 036	20	15	10	Flow -X0, pH -XX	48	224	90	52	76	112
753 318 007	753 318 037	25	20	10	Flow -X0, pH -XX	58	242	100	53	78	121
753 318 008	753 318 038	32	25	10	Flow -X0, pH -XX	65	256	110	55	81	128
753 318 009	753 318 039	40	32	10	Flow -X0, pH -XX	79	272	110	60	85	136
753 318 010	753 318 040	50	40	10	Flow -X0, pH -XX	91	294	120	66	89	147
753 318 011	753 318 041	63	50	10	Flow -X0, pH -XX	105	316	130	70	95	158

- For use with Flow: P51530-X0, 3-2536-X0, 3-8510-X0, 3-8512-X0, 3-2537-XC-X0, 3-2551-X0-XX,
- For use with pH/ORP: 3-272X-XX, 3-273X-XX
- Sensor length depends on installation fitting
- Threaded outlet 1¼ inch NPSM
- Union end with butt fusion spigot PE100
- Body and union nut PP-H



# Installation Fittings

## Type 310, ecoFIT PP-H/PE80 for Socket Systems, Metric (Available in EUROPE)

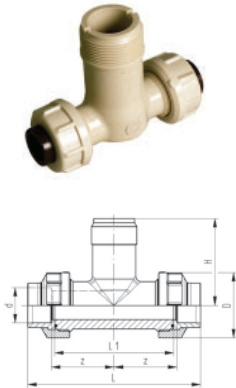

EPDM Code No.	FKM Code No.	d [mm]	DN [mm]	Sensor Type - Flow, pH/ORP	D [mm]	L [mm]	L1 [mm]	H [mm]	z [mm]
733 310 006	733 310 036	20	15	Flow -X0, pH -XX	48	128	90	76	50
733 310 007	733 310 037	25	20	Flow -X0, pH -XX	58	421	100	78	55
733 310 008	733 310 038	32	25	Flow -X0, pH -XX	65	156	110	81	60
733 310 009	733 310 039	40	32	Flow -X0, pH -XX	79	160	110	85	60
733 310 010	733 310 040	50	40	Flow -X0, pH -XX	91	176	120	89	65
733 310 011	733 310 041	63	50	Flow -X0, pH -XX	105	194	130	95	70

- For use with Flow: P51530-X0, 3-2536-X0, 3-8510-X0, 3-8512-X0, 3-2537-XC-X0, 3-2551-X0-XX,
- For use with pH/ORP: 3-272X-XX, 3-273X-XX
- Sensor length depends on installation fitting
- Threaded outlet 1 1/4 inch NPSM
- Union end with fusion socket PE80
- Body and union nut PP-H

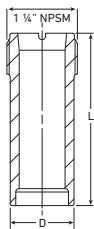

## Type 314, ecoFIT PE weldolet, Metric and Inch (Available in EUROPE)

Code No.	d [mm]	DN [mm]	Sensor Type - Flow, pH/ORP	D [mm]	L [mm]
753 314 000	75 - 180	65 - 150	Flow -X0, pH -XX	38	68
753 314 001	200 - 355	200 - 350	Flow -X1	38	102
753 314 002	400 - 630	350 - 600	Flow -X2	38	178

- For use with Flow: P51530-X0/-X1/-X2, 3-2536-X0/-X1/-X2, 3-8510-X0/-X1, 3-8512-X0/-X1, 3-2537-XC-X0/-X1, 3-2551-X0-XX/-X1-XX/-X2-XX,
- For use with pH/ORP: 3-272X-XX, 3-273X-XX
- Threaded outlet 1 1/4 inch NPSM
- Sensor length depends on installation fitting
- For conventional hot gas back welding according to DVS 2207 part 3
- Your maximum allowable pressure may be determined by the pressure rating of the pipe material, quality of weld and/or installed sensor
- pH sensors can also be used for dimensions above d180/DN150 and below d75/DN65 with 753 314 000; the length might have to be adjusted

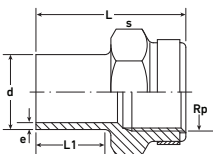

## Adapter Socket, ecoFIT PE100, SDR11 Metric - Rp (Available in EUROPE)

Code No.	d [mm]	Rp [in.]	PN [bar]	Sensor Type - Flow, pH/ORP, Conductivity	D [mm]	L [mm]	L1 [mm]	s [mm]	e [mm]
753 910 267	25	3/4	10	272X, 277X-ISO, 2839-1D - 2842-1D	25	51	23	36	2.3
753 910 269	40	1 1/4	10	2552-X2	40	57	23	55	3.7
753 910 270	50	1 1/2	10	3719-12, 2540-2/-4, 2552-X4	50	60	23	64	4.6

- Threaded outlet 1 1/4 inch NPSM
- Sensor length depends on installation fitting
- Connection via socket fusion
- Small "d" is for pipe diameter

## Transition Adapter PE/brass (CW617N) ISO female thread, Metric (Available in EUROPE)



Code No.	d [mm]	PN [bar]	Rp [in.]	Sensor Type - Flow, pH/ORP	L [mm]	z
720 920 231	63	16	1 1/4	2552-X2	85	47
720 920 241	63	16	1 1/2	3719, 2540, 2552-X4	85	47

- 16 bar water
- For electrofusion saddle (193 131 XXX and 193 135 159)

## PE Adapter ISO female thread, Metric (Available in EUROPE)



Code No.	d [mm]	PN [bar]	Rp [in.]	Sensor Type - Flow, pH/ORP	L [mm]
173 281 925	63	12.5	1 1/2	3719, 2540, 2552-X4	54

- Reinforcing ring stainless (A2)
- For electrofusion saddle (193 131 XXX and 193 135 159)

# Installation Fittings

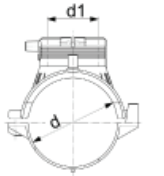

L = length / Länge

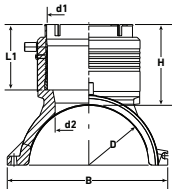

## ELGEF Plus, Electrofusion Saddle, PE100, SDR 11 (Available in EUROPE)

Code No.	d [mm]	d1	L [mm]
193 131 037	63	63	165
193 131 047	75	63	165
193 131 057	90	63	165
193 131 067	110	63	165
193 131 077	125	63	165
193 131 087	140	63	165
193 131 097	160	63	165
193 131 107	180	63	165
193 131 117	200	63	165
193 131 127	225	63	165
193 131 147	280	63	165
193 131 157	315-355	63	165

- Connection with transition adapter PE/Brass or PE adapter

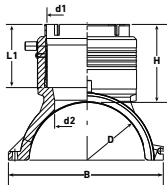

## ELGEF Plus Branch Fitting (Available in EUROPE)

Code No.	d [mm]	d1 [mm]	H [mm]	L [mm]	L1 [mm]	B [mm]	d2 [mm]
193 135 159	500 - 630	90	102	260	82	263	65

- Can be used with reduction d90 - d63 (753 908 906)
- Connection via socket fusion with transition adapter PE/brass or PE adapter

## Type 314, SYGEF Standard, PVDF, Metric/Inch (Available in EUROPE)

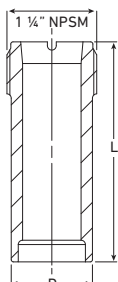

Code No.	d [mm]	DN [mm]	Sensor Type - Flow, pH/ORP	D [mm]	L [mm]
735 314 000	75 - 180	65 - 150	Flow -X0, pH -XX	37.5	68
735 314 001	200 - 355	200 - 350	Flow -X1	37.5	102
735 314 002	400 - 630	350 - 600	Flow -X2	37.5	178

- For use with Flow: P51530-X0/-X1/-X2, 3-2536-X0/-X1/-X2, 3-8510-X0/-X1, 3-8512-X0/-X1, 3-2537-XC-X0/-X1, 3-2551-X0-XX/-X1-XX/-X2-XX
- For use with pH/ORP: 3-272X-XX, 3-273X-XX
- Threaded outlet 1 1/4 inch NPSM
- Sensor length depends on installation fitting
- Please consult the instruction manual

- Installation only by trained and certified welder
- For conventional hot gas back welding according to DVS 2207 part 3
- Your maximum allowable pressure may be determined by the pressure rating of the pipe material, quality of weld and/or installed sensor
- pH sensors can also be used for dimensions above d180/DN150 and below d75/DN65 with 735 314 000; the length might have to be adjusted

Multi-Parameter Instruments  
Communication Protocol  
Chlorine  
Dissolved Oxygen  
Flow  
pH/ORP  
Conductivity/Resistivity  
Level  
Temperature  
Pressure  
Other Products  
Installation & Wiring  
Technical Reference  
Temperature/Pressure Graphs

# Installation Fittings

## Type 318, SYGEF Standard, PVDF for Butt Fusion, Metric (Available in EUROPE)

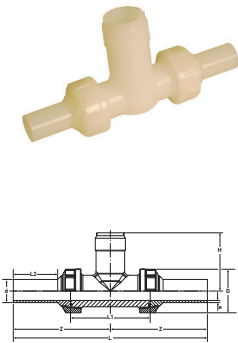

Code No.	d [mm]	DN [mm]	PN [bar]	Sensor Type - Flow, pH/ORP	D [mm]	L [mm]	L1 [mm]	L2 [mm]	H [mm]	e [mm]
735 318 036	20	15	16	Flow -X0, pH -XX	45	196	90	37	76	1.9
735 318 037	25	20	16	Flow -X0, pH -XX	55	212	100	37	78	1.9
735 318 038	32	25	16	Flow -X0, pH -XX	62	228	110	40	81	2.4
735 318 039	40	32	16	Flow -X0, pH -XX	75	234	110	40	85	2.4
735 318 040	50	40	16	Flow -X0, pH -XX	84	250	120	43	89	3.0
735 318 041	63	50	16	Flow -X0, pH -XX	101	266	130	43	95	3.0

- For use with Flow: P51530-X0, 3-2536-X0, 3-8510-X0, 3-8512-X0, 3-2537-XC-X0, 3-2551-X0-XX
- For use with pH/ORP: 3-272X-XX, 3-273X-XX
- Threaded outlet 1 1/4 inch NPSM
- Sensor length depends on installation fitting
- Union end with butt fusion spigot PVDF
- To install this installation fitting in PVC-C, PP-R and PE pipes; replace the original union ends with PVC-C, PP-R and PE union ends.

## Type 310, SYGEF Standard, PVDF, Socket Fusion, Metric (Available in USA/ASIA/EUROPE)

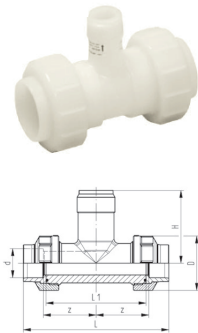

Code No.	d [mm]	Sensor Type - Flow, pH/ORP	PN [bar]	D [mm]	H [mm]	L [mm]	L1 [mm]	z [mm]
735 310 036	20	Flow -X0, pH -XX	16	45	76	128	90	50
735 310 037	25	Flow -X0, pH -XX	16	55	78	142	100	55
735 310 038	32	Flow -X0, pH -XX	16	62	81	156	110	60
735 310 039	40	Flow -X0, pH -XX	16	75	85	160	110	60
735 310 040	50	Flow -X0, pH -XX	16	84	89	176	120	65
735 310 041	63	Flow -X0, pH -XX	16	101	95	194	130	70

- For use with Flow: P51530-X0, 3-2536-X0, 3-8510-X0, 3-8512-X0, 3-2537-XC-X0, 3-2551-X0-XX
- For use with pH/ORP: 3-272X-XX, 3-273X-XX
- Union end with socket fusion part (PVDF)
- FKM O-rings
- Sensor length depends on installation fitting
- Threaded outlet 1 1/4 inch NPSM

## Type 311, SYGEF Standard, PVDF, Metric and Inch (Available in EUROPE)

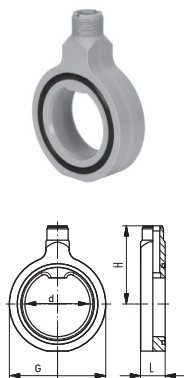

FKM Code No.	d [mm]	d [in.]	DN [mm]	PN [bar]	Sensor Type - Flow	H [mm]	D [mm]	L [mm]	L1 [mm]
735 311 042	75	2 1/2	65	16	Flow -X1	129	88	48	61
735 311 043	90	3	80	16	Flow -X1	141	102	48	69
735 311 044	110	4	100	16	Flow -X1	149	132	48	79
735 311 045	125		100	16	Flow -X1	147	132	48	79
735 311 046	140	5	125	16	Flow -X1	153	157	48	94
735 311 047	160	6	150	16	Flow -X1	161	182	48	106
735 311 049	200	8	200	16	Flow -X1	175	236	48	134
735 311 050	225	8	200	16	Flow -X1	185	236	48	134

- For use with Flow: P51530-X1, 3-2536-X1, 3-8510-X1, 3-8512-X1, 3-2537-XC-X1, 3-2551-X1-XX
- Sensor length depends on installation fitting
- Threaded outlet 1 1/4 inch NPSM
- Suitable for backing flanges metric and inch
- Delivered with profile O-ring
- Wafer can be used with other pipe materials

# Installation Fittings

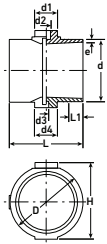

## SYGEF Plus, PVDF HP Installation Fitting, SDR33/PN10 (Available in EUROPE)

Code No.	d [mm]	Rp/NPT [in.]	PN [bar]	FM	D [mm]	e [mm]	d1 [mm]	d2 [mm]	d3 [mm]	d4 [mm]	H [mm]	L [mm]	L1 [mm]
735 918 716	140	1/4-1	10	IR	171	4.3	63	17	10	50	171	155	40
735 918 717	160	1/4-1	10	IR	189	4.9	63	17	10	50	191	155	40
735 918 720	225	1/4-1	10	IR	248	6.9	63	17	10	50	256	155	40

- For all 1/4 to 1 inch threaded sensors
- Compatible with all Signet sensors (except flow sensors)
- Thread needs to be milled, handheld drilling must not be done

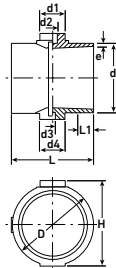

## SYGEF Plus, PVDF HP Installation Fitting, PN16 (Available in EUROPE)

Code No.	d [mm]	Rp/NPT [in.]	PN [bar]	FM	D [mm]	e [mm]	d1 [mm]	d2 [mm]	d3 [mm]	d4 [mm]	H [mm]	L [mm]	L1 [mm]
735 918 811	63	1/4-3/4	16	BCF, IR	85	3.0	40	17	10	32	89	120	25
735 918 812	75	1/4-3/4	16	BCF, IR	96	3.6	40	17	10	40	101	130	25
735 918 813	90	1/4-3/4	16	BCF, IR	110	4.3	40	17	10	40	116	130	25
735 918 814	110	1/4-3/4	16	BCF, IR	127	5.3	40	17	10	40	136	130	25
735 918 816	140	1/4-1	16	IR	171	6.7	63	17	10	50	171	155	40
735 918 817	160	1/4-1	16	IR	189	7.7	63	17	10	50	191	155	40
735 918 820	225	1/4-1	16	IR	248	10.8	63	17	10	50	256	155	40

- For all 1/4 to 1 inch threaded sensors
- Compatible with all Signet sensors (except flow sensors)
- Thread needs to be milled, handheld drilling must not be done

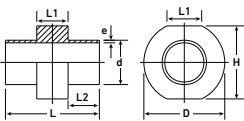

## SYGEF Plus, PVDF HP Installation Fitting, PN16 (Available in EUROPE)

Code No.	d [mm]	DN [mm]	Rp/NPT [in.]	PN [bar]	FM	D [mm]	H [mm]	L [mm]	L1 [mm]	L2 [mm]	e [mm]
735 918 615	125	100	1/8 - 3/4	16	IR	162	157	100	40	27	6.0
735 918 616	140	125	1/8 - 3/4	16	IR	176	171	110	40	32	6.7
735 918 617	160	150	1/8 - 3/4	16	IR	194	190	110	40	32	7.7
735 918 619	200	200	1/8 - 3/4	16	IR	231	228	110	40	32	9.6
735 918 620	225	200	1/8 - 3/4	16	IR	254	251	110	40	32	10.8
735 918 621	250	250	1/8 - 3/4	16	IR	277	274	160	40	60	11.9
735 918 622	280	250	1/8 - 3/4	16	IR	304	307	160	40	60	13.4
735 918 623	315	300	1/8 - 3/4	16	IR	336	334	160	40	60	15.0

- For all 1/8 to 3/4 inch threaded sensors
- Compatible with all Signet sensors (except flow sensors)
- Thread needs to be milled, handheld drilling must not be done

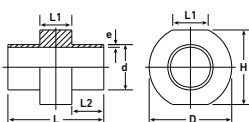

## SYGEF Plus, PVDF HP Installation Fitting, PN10 (Available in EUROPE)

Code No.	d [mm]	DN [mm]	Rp/NPT [in.]	PN [bar]	FM	D [mm]	H [mm]	L [mm]	L1 [mm]	L2 [mm]	e [mm]
735 918 565	125	100	1/8 - 3/4	10	IR	162	157	100	40	27	3.9
735 918 566	140	125	1/8 - 3/4	10	IR	176	171	110	40	32	4.4
735 918 567	160	150	1/8 - 3/4	10	IR	194	190	110	40	32	4.9
735 918 569	200	200	1/8 - 3/4	10	IR	231	228	110	40	32	6.2
735 918 570	225	200	1/8 - 3/4	10	IR	254	251	110	40	32	7.0

- For all 1/8 to 3/4 inch threaded sensors
- Compatible with all Signet sensors (except flow sensors)
- Thread needs to be milled, handheld drilling must not be done

# Installation Fittings

## SYGEF Standard, PVDF, ANSI - NPT Female Thread, PN 16 (Available in EUROPE)

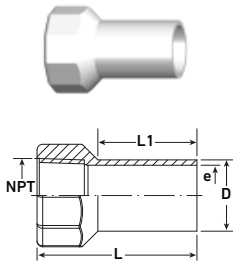

Code No.	d [mm]	NPT [in.]	PN [bar]	FM	Sensor Type - Flow, pH/ORP, Conductivity, Temperature, Pressure	L [mm]	D [mm]	sw	L1 [mm]	e [mm]
735 914 587	25	¾	16	BCF, IR	272X, 277X, 2819-2842, 2350, 2450	58	25	38	30	1.9
735 914 588	32	1	16	BCF, IR	276X	63	32	48	30	2.4
735 914 589	40	1¼	16	BCF, IR	2552-X1	67	40	58	30	2.4
735 914 590	50	1½	16	BCF, IR	3719-11, 2540-1/-3, 2552-X3	67	50	65	30	3.0
735 914 591	63	2	16	BCF, IR	3719-21	73	63	80	30	3.0

- Check L1 value vs. sensor length regarding minimum insertion depth
- Also available in SYGEF Plus (PVDF-HP) in all dimensions: Code No. 735 914 787 etc.)
- Connection via BCF or IR fusion
- Small "d" is for pipe dimension

## SYGEF Standard, PVDF for ISO Rp Female Thread, PN 16 (Available in EUROPE)

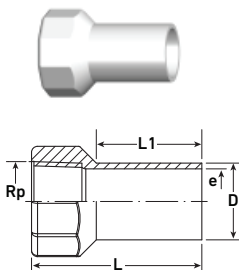

Code No.	d [mm]	Rp [in.]	PN	FM	Sensor Type - Flow, pH/ORP, Conductivity	D [mm]	L [mm]	sw	L1 [mm]	e [mm]
735 910 587	25	¾	16	BCF, IR	272X, 277X-ISO, 2839-1D-2842-1D	25	57	38	30	1.9
735 910 289	40	1¼	16	BCF, IR	2552-X2	40	66	58	30	2.4
735 910 290	50	1½	16	BCF, IR	3719-12, 2540-2/-4, 2552-X4	50	66	65	30	3.0
735 910 591	63	2	16	BCF, IR	3719-22	63	73	80	30	3.0

- Check L1 value vs. sensor length regarding minimum insertion depth
- Also available in SYGEF Plus (PVDF-HP) in all dimensions: Code No. 735 914 787 etc.)
- Connection via BCF or IR fusion
- Small "d" is for pipe dimension

## Type 310, ABS, Metric (Available in EUROPE)

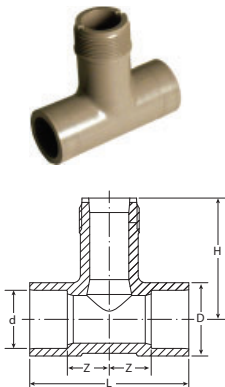

Code No.	d [mm]	DN [mm]	PN [bar]	Sensor Type	D [mm]	L [mm]	H [mm]	z [mm]	closest [inch]
729 310 007	25	20	10	Flow -X0, pH -XX	35	100	78	32	¾
729 310 008	32	25	10	Flow -X0, pH -XX	44	110	81	33	1
729 310 009	40	32	10	Flow -X0, pH -XX	51	110	84	29	1¼
729 310 010	50	40	10	Flow -X0, pH -XX	63	120	88	29	1½
729 310 011	63	50	10	Flow -X0, pH -XX	78	130	94	28	2

- For use with Flow: P51530-X0, 3-2536-X0, 3-8510-X0, 3-8512-X0, 3-2537-XC-X0, 3-2551-X0-XX,
- For use with pH/ORP: 3-272X-XX, 3-273X-XX
- Threaded outlet 1¼ inch NPSM
- Sensor length depends on installation fitting
- With solvent cement socket metric

## Type 312, ABS Glue-on Saddle, Metric (Available in EUROPE)

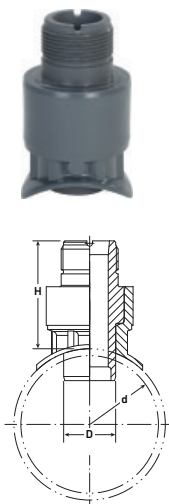

Code No.	d [mm]	DN [mm]	PN [bar]	Sensor Type - Flow	D [mm]	H [mm]	closest [inch]
729 312 012	75	65	10	Flow -X1	38	91	2½
729 312 013	90	80	10	Flow -X1	38	91	3
729 312 014	110	100	10	Flow -X1	38	91	4
729 312 016	140	125	10	Flow -X1	38	81	5
729 312 017	160	150	10	Flow -X1	38	77	6
729 312 019	200	200	10	Flow -X1	38	71	8
729 312 020	225	200	10	Flow -X1	38	67	8

- For use with Flow: P51530-X1, 3-2536-X1, 3-8510-X1, 3-8512-X1, 3-2537-XC-X1, 3-2551-X1-XX
- Threaded outlet 1¼ inch NPSM
- Sensor length depends on installation fitting
- Top saddle for solvent cement bonding

# Installation Fittings

## Type 313, COOL-FIT, pre-insulated, Metric (Available in EUROPE)

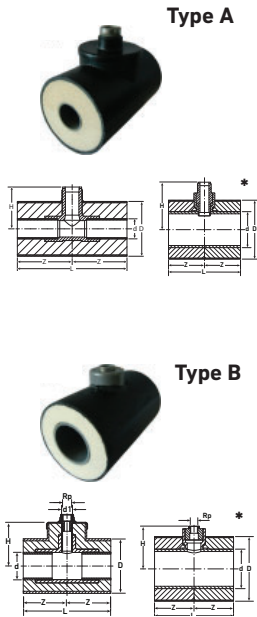

Type	Code No.	d [mm]	Rp [in.]	DN [mm]	PN [bar]	Required nipple	D [mm]	L [mm]	H [mm]	z [mm]	closest [in.]
A	738 313 007	25	½	20	10	738 901 107	90	160	102	80	¾
A	738 313 008	32	½	25	10	738 901 108	90	160	102	80	1
A	738 313 009	40	½	32	10	738 901 109	110	180	112	90	1¼
A	738 313 010	50	½	40	10	738 901 110	110	180	112	90	1½
A	738 313 011	63	½	50	10	738 901 111	125	200	122	100	2
A	738 313 012	* 75	½	65	10	738 901 112	140	250	153	125	2½
A	738 313 013	* 90	½	80	10	738 901 113	160	280	168	140	3
B	738 313 114	* 110	½	100	10	738 901 114	180	220	119	110	4
B	738 313 116	* 140	½	125	10	738 901 116	225	220	134	110	5
B	738 313 117	* 160	½	150	10	738 901 117	250	220	145	110	6
B	738 313 119	* 200	½	200	10	738 901 119	280	250	165	125	8
B	738 313 120	* 225	½	200	10	738 901 120	315	280	178	140	8

### Type A

- Threaded outlet ½ Rp
- Insulation made from PUR
- Outer jacket impact resistant. Color: black

### Type B

- With ½ inch Rp threaded branch for sensors (i.e. pressure)
- Insulation made from PUR
- Outer jacket impact resistant. Color: black

## Type 310, COOL-FIT, pre-insulated, Metric (Available in EUROPE)

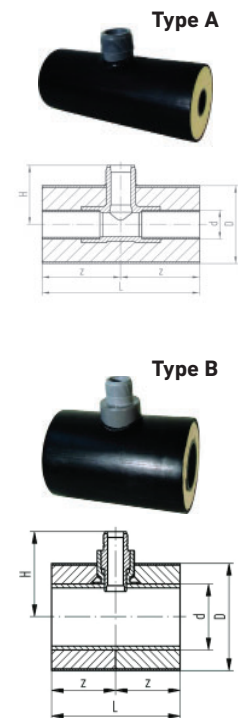

Type	Code No.	d [mm]	D [mm]	PN [bar]	Required nipple	Sensor Type - Flow, pH/ORP	H [mm]	L [mm]	z [mm]	closest [in.]
A	738 310 107	25	90	10	738 901 107	Flow -X0, pH -XX	78	220	110	¾
A	738 310 108	32	90	10	738 901 108	Flow -X0, pH -XX	81	220	110	1
A	738 310 109	40	110	10	738 901 109	Flow -X0, pH -XX	84	220	110	1
A	738 310 110	50	110	10	738 901 110	Flow -X0, pH -XX	88	220	110	1½
A	738 310 111	63	125	10	738 901 111	Flow -X0, pH -XX	94	220	110	2
B	738 310 112	75	140	10	738 901 112	Flow -X1	161	220	110	2½
B	738 310 113	90	160	10	738 901 113	Flow -X1	171	220	110	3
B	738 310 114	110	180	10	738 901 114	Flow -X1	181	220	110	4
B	738 310 116	140	225	10	738 901 116	Flow -X1	193	220	110	5
B	738 310 117	160	250	10	738 901 117	Flow -X1	202	220	110	6
B	738 310 119	200	280	10	738 901 119	Flow -X1	211	250	125	8
B	738 310 120	225	315	10	738 901 120	Flow -X1	225	280	140	8

### Type A and B

- For use with Flow: P51530-X0/-X1, 3-2536-X0/-X1, 3-8510-X0/-X1, 3-8512-X0/-X1, 3-2537-XC-X0/-X1, 3-2551-X0-XX/-X1-XX
- For use with pH/ORP: 3-272X-XX, 3-273X-XX
- Threaded outlet 1¼ NPSM
- Insulation made from PUR
- Outer jacket impact resistant. Color: black

### Type B

- With ½ inch Rp threaded branch for sensors (i.e. pressure)
- Insulation made from PUR
- Outer jacket impact resistant. Color: black

# Installation Fittings

## Type 313, COOL-FIT 2.0, Pre-insulated, Metric (Available in EUROPE)

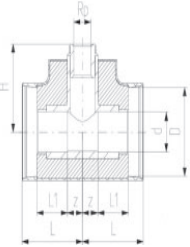

Type B

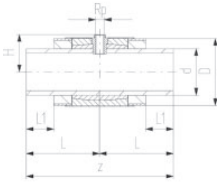

Type	Code No.	d / D [mm]	PN [bar]	Rp [inch]	L [mm]	L1 [mm]	H [mm]	z [mm]	closest [in.]
A	738 313 408	32/75	16	½	73	36	75	16	1
A	738 313 409	40/90	16	½	81	40	85	21	1¼
A	738 313 459	40/90	16	¾	81	40	88	21	1¼
A	738 313 410	50/90	16	½	88	44	94	24	1½
A	738 313 460	50/90	16	¾	88	44	97	24	1½
A	738 313 411	63/110	16	½	97	48	113	29	2
A	738 313 461	63/110	16	¾	97	48	116	29	2
A	738 313 412	75/125	16	½	110	55	99	35	2½
A	738 313 462	75/125	16	¾	110	55	102	35	2½
A	738 313 413	90/140	16	½	123	62	113	42	3
A	738 313 463	90/140	16	¾	123	62	116	42	3
A	738 313 414	110/160	16	½	148	72	128	56	4
A	738 313 464	110/160	16	¾	148	72	131	56	4
B	738 313 416	140/200	16	½	224	84	110	447	5
B	738 313 466	140/200	16	¾	224	84	113	447	5

### Type A

- Pre-insulated PE100 SDR11, metric
- Insulation made from GF HE foam
- Impact resistant. Color: black
- With threaded branch for sensors (i.e. temperature, pressure)
- Electrofusion Fitting with integrated sealing lip, for a moisture-proof and vapor tight sealing

### Type B

- Pre-insulated PE100 SDR11, metric
- Insulation made from GF HE foam
- Impact resistant. Color: black
- With threaded branch for sensors (i.e. temperature, pressure)
- Spigot Fitting with free end (separate electrofusion fitting needed for joining)

## Type 314, Stainless Steel, Metric (Available in EUROPE)

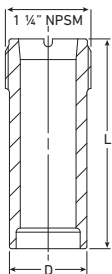

Code No.	d [mm]	DN [mm]	Sensor Type - Flow, pH/ORP	D [mm]	L [mm]
724 314 000	63 - 180	50 - 150	Flow -X0/ pH -XX	38	68
724 314 001	200 - 355	200 - 350	Flow -X1	38	102
724 314 002	400 - 630	350 - 600	Flow -X2	38	178

- For use with Flow: P51530-X0/-X1/-X2, 3-2536-X0/-X1/-X2, 3-8510-X0/-X1, 3-8512-X0/-X1, 3-2537-XC-X0/-X1, 3-2551-X0-XX/-X1-XX/-X2-XX
- For use with pH/ORP: 3-272X-XX, 3-273X-XX

- Threaded outlet 1¼ inch NPSM
- pH sensors can also be used for dimensions above d180/DN150 and below d63/DN50 with 724 314 000; the length might have to be adjusted

# Installation Fittings

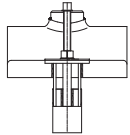
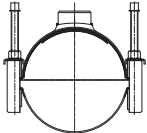

## Multi/Clamp Saddle Studs Threaded Outlet 3/4 Inch (Available in EUROPE)

Code No.	Range [mm]	PN Water	Sensor Type - pH/ORP, Temperature, Pressure
724 201 062	68 - 78	16	2350, 2450, 272X, 273X, 276X, 277X
724 201 074	88 - 110	16	2350, 2450, 272X, 273X, 276X, 277X
724 201 098	108 - 134	16	2350, 2450, 272X, 273X, 276X, 277X
724 201 134	133 - 155	16	2350, 2450, 272X, 273X, 276X, 277X
724 201 170	159 - 181	16	2350, 2450, 272X, 273X, 276X, 277X
724 201 194	168 - 190	16	2350, 2450, 272X, 273X, 276X, 277X
724 201 206	190 - 212	16	2350, 2450, 272X, 273X, 276X, 277X
724 201 218	216 - 238	16	2350, 2450, 272X, 273X, 276X, 277X
724 201 242	238 - 260	16	2350, 2450, 272X, 273X, 276X, 277X
724 201 254	267 - 289	16	2350, 2450, 272X, 273X, 276X, 277X

- Saddle with threaded outlet
- The rubber gasket is available in NBR (EPDM on request)

- Lower shell half is without gasket (available on request)

## Multi/Clamp Saddle Studs Threaded Outlet 1 1/4 Inch (Available in EUROPE)

Code No.	Range [mm]	PN Water	Sensor Type - Flow
724 201 076	88 - 110	16	2552
724 201 100	108 - 134	16	2552
724 201 136	133 - 155	16	2552
724 201 172	159 - 181	16	2552
724 201 196	168 - 190	16	2552
724 201 208	190 - 212	16	2552
724 201 220	216 - 238	16	2552
724 201 244	238 - 260	16	2552
724 201 256	267 - 289	16	2552

- Saddle with threaded outlet
- The rubber gasket is available in NBR (EPDM on request)

- Lower shell half is without gasket (available on request)

## Multi/Clamp Saddle Studs Threaded Outlet 1 1/2 Inch (Available in EUROPE)

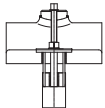
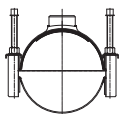

Code No.	Range [mm]	PN Water	Sensor Type - Flow, pH/ORP
724 201 101	108 - 134	16	2552, 2540, 3719
724 201 137	133 - 155	16	2552, 2540, 3719
724 201 173	159 - 181	16	2552, 2540, 3719
724 201 197	168 - 190	16	2552, 2540, 3719
724 201 209	190 - 212	16	2552, 2540, 3719
724 201 221	216 - 238	16	2552, 2540, 3719
724 201 245	238 - 260	16	2552, 2540, 3719
724 201 257	267 - 289	16	2552, 2540, 3719

- For use with Flow: 2552, 2540
- For use with pH/ORP: 3719
- Saddle with threaded outlet

- The rubber gasket is available in NBR (EPDM on request)
- Lower shell half is without gasket (available on request)

## Multi/Clamp Saddle Studs Threaded Outlet 2 Inch (Available in EUROPE)

Code No.	Range [mm]	PN Water	Sensor Type - pH/ORP
724 201 102	108 - 134	16	3719
724 201 138	133 - 155	16	3719
724 201 174	159 - 181	16	3719
724 201 198	168 - 190	16	3719
724 201 210	190 - 212	16	3719
724 201 222	216 - 238	16	3719
724 201 246	238 - 260	16	3719
724 201 258	267 - 289	16	3719

- Saddle with threaded outlet
- The rubber gasket is available in NBR (EPDM on request)

- Lower shell half is without gasket (available on request)



# Fitting Insert Reference

The following inserts can be used to replace inserts in Signet fittings

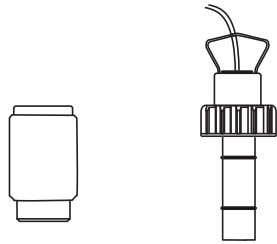

Sensor Plug

Fitting	Insert Part No.	Description
<b>Fitting Accessories</b>		
P31515-0V200	159 000 459	Pipe Adapter Insert, PVDF
P31515-0C200	159 000 631	Pipe Adapter Insert, CPVC
P31515-0P200	159 000 630	Pipe Adapter Insert, PVC
P31520-1V	159 000 460	Pipe Adapter Insert, PVDF
P31520-2P	159 000 461	Pipe Adapter Insert, PVC
P31536	198 840 201	Sensor Plug, Polypro
P31671-1	159 000 465	Insert, PVDF 1½ in.

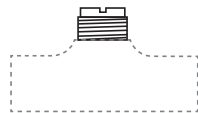
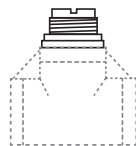
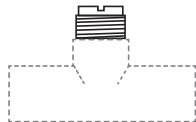
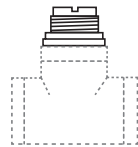
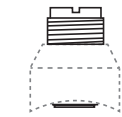

Fitting	Insert Part No.	Description
<b>Brazolet Fittings</b>		
BR4B025	P31515-0V200	Brazolet, Brass
BR4B030	P31515-0V200	Brazolet, Brass
BR4B040	P31515-0V200	Brazolet, Brass
BR4B050	P31520-1V	Brazolet, Brass
BR4B060	P31520-1V	Brazolet, Brass
BR4B080	P31520-1V	Brazolet, Brass
BR4B100	P31520-2P	Brazolet, Brass
BR4B120	P31520-2P	Brazolet, Brass

Fitting	Insert Part No.	Description
<b>Tee Fittings</b>		
BR4T010	P31515-0V200	Tee, Brass
BR4T012	P31515-0V200	Tee, Brass
BR4T015	P31515-0V200	Tee, Brass
BR4T020	P31515-0V200	Tee, Brass
CUKT005	Not applicable	Tee, Copper
CUKT007	Not applicable	Tee, Copper
CUKT010	Not applicable	Tee, Copper
CUKT012	P31515-0V200	Tee, Copper
CUKT015	P31671-1	Tee, Copper
CUKT020	P31520-1V	Tee, Copper
CR4T005	P31515-0V200	Tee, SS
CR4T007	P31515-0V200	Tee, SS
CR4T010	P31515-0V200	Tee, SS
CR4T012	P31515-0V200	Tee, SS
CR4T015	P31671-1	Tee, SS
CR4T020	P31520-1V	Tee, SS
CS4T005	P31515-0V200	Tee, Carbon Steel
CS4T007	P31515-0V200	Tee, Carbon Steel
CS4T010	P31515-0V200	Tee, Carbon Steel
CS4T012	P31515-0V200	Tee, Carbon Steel
CS4T015	P31515-0V200	Tee, Carbon Steel
CS4T020	P31515-0V200	Tee, Carbon Steel
FPT015	P31515-0V200	Tee, Fiberglass
FPT020	P31515-0V200	Tee, Fiberglass



**FOR YOUR SAFETY:** Always confirm the chemical compatibility and the maximum pressure/temperature specifications for fitting and sensor selection prior to purchase. Failure to do so may result in property damage and/or serious personal injury.

# Fitting Insert Reference

Fitting	Insert Part No.	Description
<b>Tee Fittings</b>		
IR4T010	P31515-0V200	Tee, Iron
IR4T012	P31515-0V200	Tee, Iron
IR4T015	P31515-0V200	Tee, Iron
IR4T020	P31515-0V200	Tee, Iron
<b>Weldolet Fittings</b>		
CR4W025	P31515-0V200	Weldolet, SS
CR4W030	P31515-0V200	Weldolet, SS
CR4W040	P31515-0V200	Weldolet, SS
CR4W050	P31520-1V	Weldolet, SS
CR4W060	P31520-1V	Weldolet, SS
CR4W080	P31520-1V	Weldolet, SS
CR4W100	P31520-2P	Weldolet, SS
CR4W120	P31520-2P	Weldolet, SS
CS4W025	P31515-0V200	Weldolet, Carbon Steel
CS4W030	P31515-0V200	Weldolet, Carbon Steel
CS4W040	P31515-0V200	Weldolet, Carbon Steel
CS4W050	P31520-1V	Weldolet, Carbon Steel
CS4W060	P31520-1V	Weldolet, Carbon Steel
CS4W080	P31520-1V	Weldolet, Carbon Steel
CS4W100	P31520-2P	Weldolet, Carbon Steel
CS4W120	P31520-2P	Weldolet, Carbon Steel
<b>Saddle Fittings</b>		
IR8S020	P31515-0V200	Saddle, Iron
IR8S025	P31515-0V200	Saddle, Iron
IR8S030	P31515-0V200	Saddle, Iron
IR8S040	P31515-0V200	Saddle, Iron
IR8S050	P31520-1V	Saddle, Iron
IR8S060	P31520-1V	Saddle, Iron
IR8S080	P31520-1V	Saddle, Iron
IR8S100	P31520-2P	Saddle, Iron
IR8S120	P31520-2P	Saddle, Iron
PV8S020	Not applicable	Saddle, PVC
PV8S025	Not applicable	Saddle, PVC
PV8S030	Not applicable	Saddle, PVC
PV8S040	Not applicable	Saddle, PVC
PV8S060	Not applicable	Saddle, PVC
PV8S080	Not applicable	Saddle, PVC
PV8S100	Not applicable	10 in. Glue-on Saddle, PVC
PV8S120	Not applicable	12 in. Glue-on Saddle, PVC

## Ordering Notes

- If insert is intended for use with Signet installation fittings, specify fitting part number at the time of purchase.
- If insert is not for use with Signet installation fittings, specify the following at the time of purchase:
  - Outside diameter (o.d.) of pipe
  - Thickness of pipe
  - Dimension from top of pipe to top of installation fitting when installed.